

Instruction Manual

Stainless Steel Vacuum Carafe

Model No. SH-RA

Please read these instructions before use,
and keep for future reference.

● Be sure that all parts are attached firmly before each use.

Name of Each Part

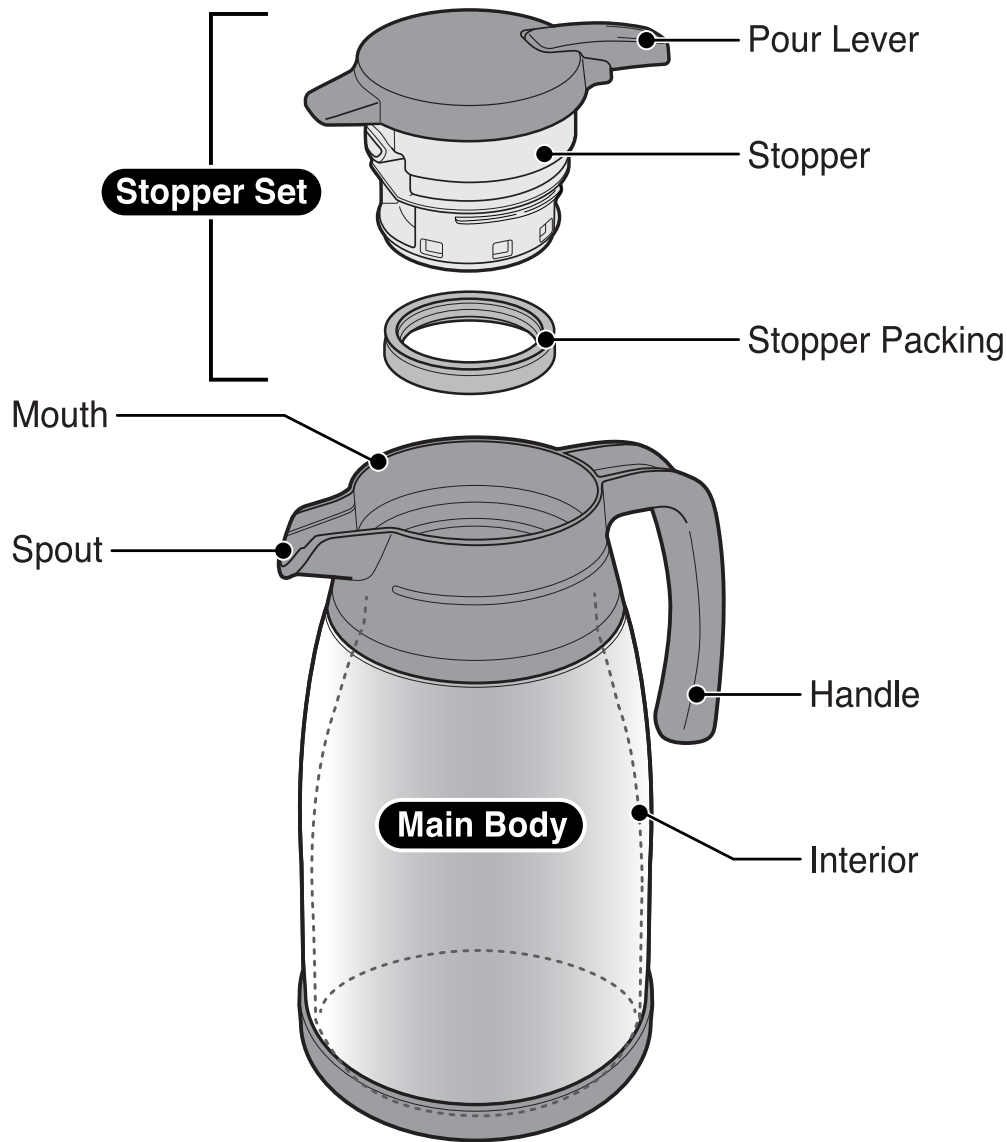

● The illustrations used in this instruction manual may vary from the actual product you have purchased.

SH- RA(E/K) / A

Important Safeguards

Please follow these instructions to prevent scalding, deterioration and discoloration of beverages, and malfunction or staining of the Carafe.

Keep out of the reach of infants and small children. Do not allow them to play with this product.
Mishandling may cause injury or scalding.

Do not use in direct sunlight or near open flames from sources such as stoves.
Doing so may cause scalding, deformation or discoloration of the Carafe.

Leave 1 cm (1/2 inch) of space on top when filling the Carafe.
Closing the Stopper Set with too much beverage may cause overflow. It may also cause leaks later.

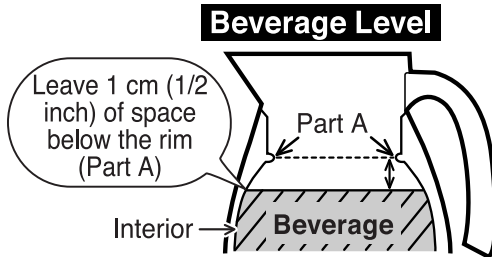

Do not press the Pour Lever with the Carafe close to your face or with the Spout tilted toward you.
Hot beverages or steam may suddenly come out and cause scalding.

Do not place inside moving vehicles when filled.
Doing so may cause burns, stains, or damage.

Do not use the Carafe if it loses its heat retention properties.
The outside of the Main Body will become very hot when filled with hot beverage and may cause burns.

Do not remove the sticker on the bottom of the Main Body.
Doing so may cause rust or pinholes.



Do not disassemble the Main Body.

Use only to keep beverages hot or cold.
This Carafe is for keeping beverages hot or cold.

Hold the handle firmly when carrying the Carafe.

● **Do not tilt the Carafe or carry it on its side.**

Doing so may cause burns or stains.

● **Do not hold the Carafe by the Stopper Set or Pour Lever.**

The Carafe could fall, posing a hazard.

● **Do not press the Pour Lever while carrying the Carafe.**

Beverages may spill and cause burns or stain clothes.

Do not turn the Carafe on its side when filled with a beverage.

Hot beverages may leak and cause scalding or stains, even if the Pour Lever is closed.

Avoid dropping or hitting the Carafe against hard surfaces.

Damage to plastic parts or the stainless steel surface of the Carafe may reduce its ability to retain heat.

Do not place near open flames (from gas stoves) or on top of electric heaters or IH cooking devices.

Doing so may cause fire, burns, or damage.

When removing the Stopper Set, press the Pour Lever once to release steam before removing the Stopper Set.

Failure to do so may cause the Stopper Set to pop off and release steam, which may lead to injury or burns.

Always make sure that the Stopper Packing is attached during use.

Hot beverages may leak and cause scalding. It may also cause stains.

Always close the Stopper Set securely.

If the Stopper Set comes off, beverages may spill and cause burns.

Clean the Stopper, Stopper Packing, and the Interior immediately after every use.

Not cleaning thoroughly may cause the Main Body to rust, pinholes to form, or beverages to spoil. Additionally, mold may form if the Carafe is left unwashed.

Important Safeguards (continued)

Consume beverages within the same day to prevent spoilage.

Leaving a beverage in the Carafe for an extended period of time may cause spoilage and increase gas pressure inside the Main Body, causing the Stopper Set to pop off and beverages to spill, resulting in injury.

Do not fill the Carafe with the following:

- **Dry ice or carbonated drinks:**

The pressure inside the Main Body could rise, causing the Stopper Set to pop off and beverages to spill, resulting in injury.

- **Dairy products or fruit juice:**

If left inside for a long period of time, contents may spoil and increase gas pressure inside the Main Body, causing the Stopper Set to pop off, resulting in injury.

- **Liquids high in sodium such as soup or Kōbu-cha:**

Although the liner is made of 18/8 stainless steel, salt could cause rust, resulting in loss of thermal insulation.

- **Fruit pulp or tea leaves:**

Contents could clog the Stopper Packing or cause leaks.

Warnings & Cautions

Do not allow a hot kettle to touch the mouth of the Main Body.

Doing so may cause burns if the Carafe is tipped over.

It may also cause scratches or deformation of the Carafe.

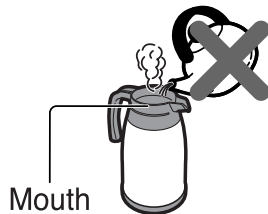

Do not scrape or rub the design on the Main Body with excessive force.

The design may come off.

When keeping hot drinks warm, the pressure inside the Main Body cause a small amount of steam to escape through the Stopper Set, making a hissing sound. If the sound continues, press the Pour Lever to release any steam.

It is designed to release pressure for safety purposes, and does not indicate a malfunction.

Hot tea may discolor when stored for a long period of time. We recommend filling the Main Body with hot water, and using a small teapot or tea bags to brew tea.

After cleaning the Stopper Set, shake it well to remove excess water while depressing the Lever, then wipe it thoroughly.

Water left inside the Stopper Set may leak out.

Do not force large ice cubes into the Carafe.

Doing so may cause deformation or damage the Carafe.

Do not place cans or bottles inside the Main Body.

Doing so may cause deformation or damage the Carafe.

The rattling noise that may be heard when the Carafe is shaken comes from the metallic foil used in the vacuum insulation to increase heat (cold) retention and does not indicate a malfunction.

Using the Carafe

● Before use, rinse the Stopper Set and the Interior thoroughly with lukewarm water.

- The first time you use the product you may notice the smell of plastic. This is normal and will gradually fade away.
- Always make sure that the Stopper Packing is properly attached before use.

Failure to do so may cause contents to leak. (See pg. 6 “Removing and Attaching the Stopper Packing” for details.)

- Keep the Carafe upright when transporting it.

To keep pressure from building up inside the Carafe, there is a slight gap in the Stopper Set. Exercise caution as contents may leak from the Spout if the Carafe is tilted, even if the Pour Lever is not pressed down.



1 Remove the Stopper Set.

Hold the handle with one hand and remove the Stopper Set by rotating in the direction shown by the arrow.

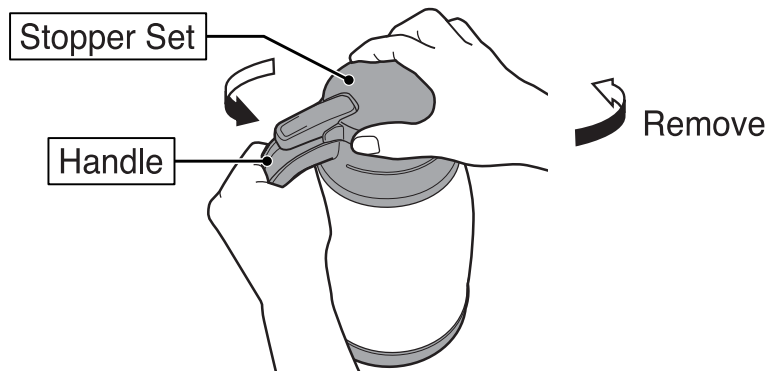

2 Fill the Carafe and attach the Stopper Set.

Hold the handle with one hand and fully close the Stopper Set by gradually rotating it in the direction indicated by the arrow.

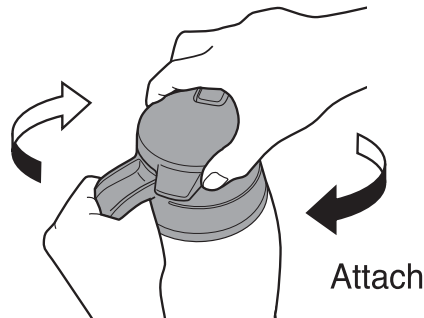

- Attach the Stopper Set securely so that the Pour Lever is aligned with the handle.

For better heat retention, preheat (precool) the Main Body for about 1 minute before filling with your beverage.

Beverage Level

Leave 1 cm (1/2 inch) of space below the rim (Part A)

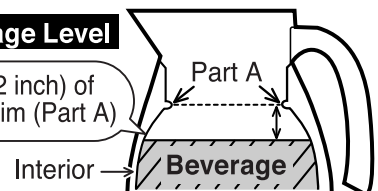

Using the Carafe (continued)

3 Pouring beverages:

① Hold the handle and press down the Pour Lever while keeping the Main Body upright.

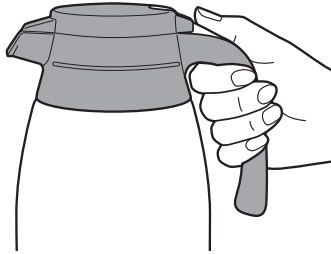

② Keep the Pour Lever pressed down and tilt the Carafe to pour.

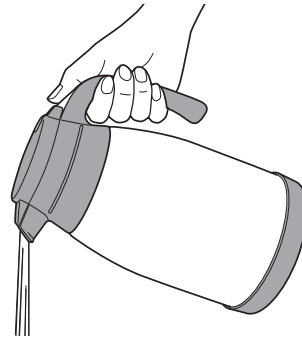

4 After pouring:

① While holding and pressing the Pour Lever, stand the Carafe upright.

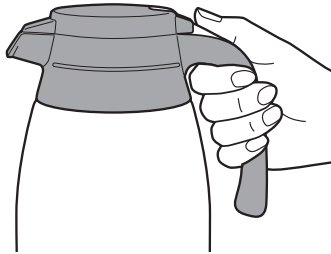

② Release the Pour Lever.

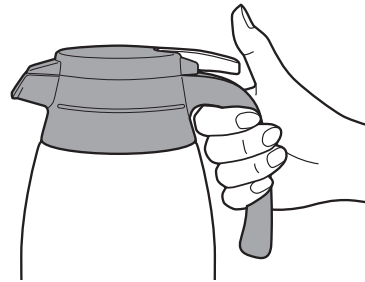

Caution

If the Pour Lever is released while the Carafe is tilted, beverages will sit in the Stopper Set and cause leakage during use, resulting in burns or stains.

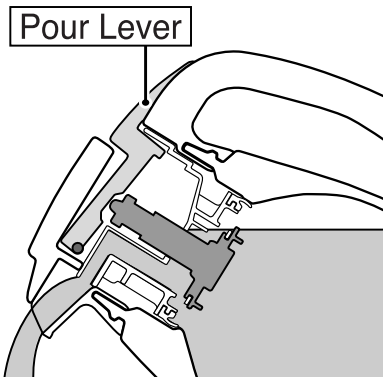

If the Pour Lever is released while the Carafe is tilted.



Beverages will sit in the Stopper Set.

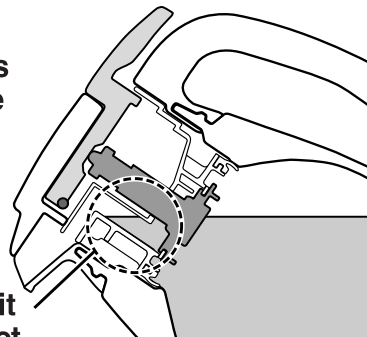

Removing and Attaching the Stopper Packing

To Remove

Remove the Stopper Packing.

Stopper Packing

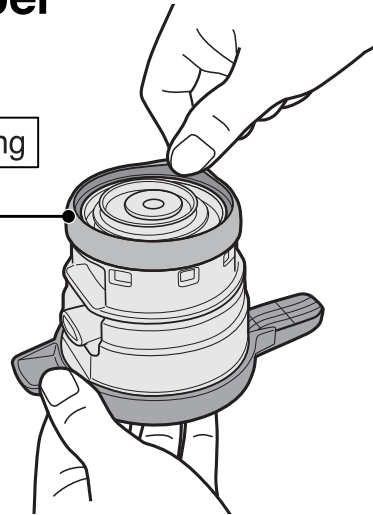

To Attach

Attach the Stopper Packing.

Align the recess in the Stopper Packing with the ridge on the Stopper and push it into place while applying pressure from the outside in.

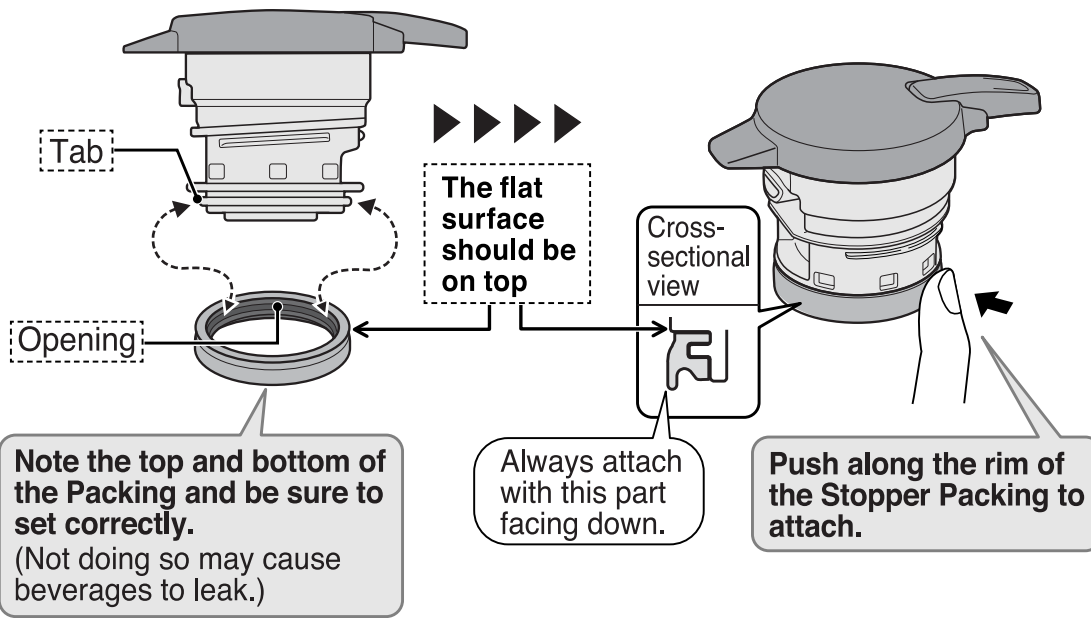

Taking Care of Your Carafe

● Clean the product after each use to prevent odors, stain, mold, and to keep the product sanitary.

● Always remove the Stopper Packing before cleaning. (See pg. 6)

Stopper Set

- ① Wash the Stopper and Stopper Packing with warm water and mild dishwashing liquid using a soft sponge.
 - ② Allow water to flow through the Stopper while pressing down the Pour Lever as shown in the illustration.
 - ③ Rinse, shake a few times, gently wipe away any moisture, and allow to dry.
- Use a small brush sold in stores if necessary.

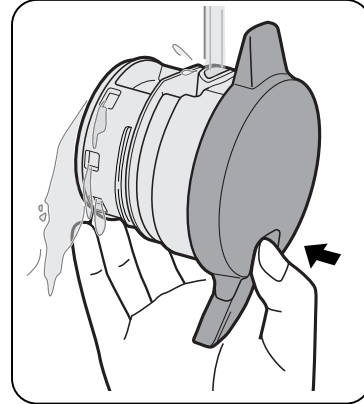

As shown in the illustration, shake the Stopper Set up and down several times while pressing down the Pour Lever to drain water trapped inside through the water drip opening and wipe dry.

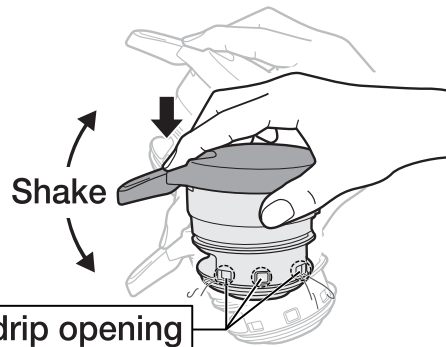

Interior

- ① Wash with warm water and mild dishwashing liquid using a soft sponge with a handle.
- ② Then rinse dry completely.

Exterior

- ① Wash with warm water and mild dishwashing liquid using a soft sponge.
- ② Rinse, shake a few times, gently wipe away any moisture, and allow to dry.

Taking Care of Your Carafe (continued)

When Cleaning Your Carafe:

- Do not use a dishwasher or dish-dryer. Do not boil to sanitize.
- Do not clean using paint thinner, metal wire scrub brushes, scrubbing brushes that include abrasive cleaners, polishing powders, cleansers, eraser pads, or other similar items.
Doing so may damage the product.
- Do not use chlorine-based bleach. In addition, do not use any kind of bleach, even non-chlorine-based, to clean the outside of the Main Body. Bleach may damage the paint, print, or stickers on the Main Body.
- Do not soak in water for an extended period of time.
- If the product is not going to be used for an extended period, wash thoroughly with cold or lukewarm water and dry well. Store the product away from high temperatures and humidity.
High temperatures and humidity may damage the product.

To Remove Rust Spots and Water Stains:

You may find rust spots or water stains caused by impurities in the water. To remove these stains, fill the Main Body with hot water with 10% vinegar and allow to stand for 30 minutes to an hour without attaching the Stopper Set. Then wash the Interior thoroughly.

To Remove Coffee and Tea Stains:

To remove coffee and tea stains from the Interior and the Stopper Set, we recommend using Zojirushi's cleaning detergent SB-ZA01/SB-ZA01E. Always remove the Stopper Set when using SB-ZA01/SB-ZA01E.

- Contact Zojirushi Customer Service or your local dealer for further information.

Taking Care of Your Carafe (continued)

We take care in only using materials that are safe and hygienic for food contact. However, if plastic parts become damaged or their surface becomes rough, please replace them for optimum performance. The Stopper Set or Stopper Packing may need to be replaced due to time and wear. Please check them about once a year. When replacing parts, please record the model number and part name beforehand. Then contact either the store where you purchased the product or Zojirushi Customer Service. Replacement parts may be available for an additional charge.