

Thank you for your purchase of this quality Zojirushi product. We are confident that it will give you top performance and optimum satisfaction for many years. To ensure this, please read and follow the important guidelines below.

How to Use:

1. Remove outer lid (cup) and stopper.
2. For maximum temperature retention, fill with hot (or cold) water for 1-2 minutes. Pour this water out.

3. Pour beverage into the bottle and replace the stopper.

*To open, stand the bottle upright and push the button on top.

*Tilt the bottle to pour. After pouring, stand the bottle upright and push in the switch on the side to close.

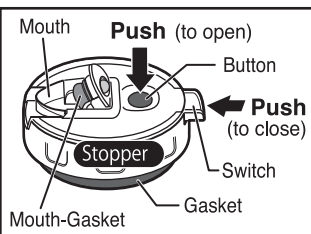

Tip:

To avoid minor overflow when placing the stopper into the bottle, leave at least one-half inch (1/2") room below the rim of the bottle when filling.

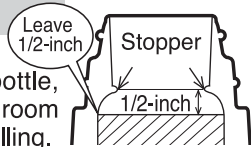

How to Use the Handle:

To pull handle out:

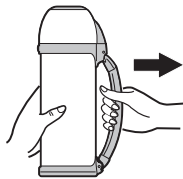

To push handle in:

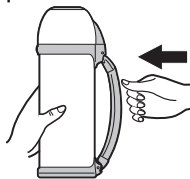

How to Clean the Stopper:

1. Push the button to open.
2. Remove the gasket as shown.
3. Wash the stopper and gasket.

*After washing, shake the stopper several times to remove water left inside. Wipe off water on the stopper.

Hand-Wash Only

Not Dishwasher Safe

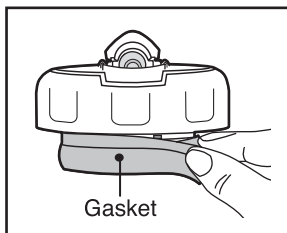

How to Replace the Gasket:

*Replacing the gasket incorrectly may cause leaks.

Gasket:

Fit the gasket on the stopper by gently pressing.

Make sure the gasket is fit all around.

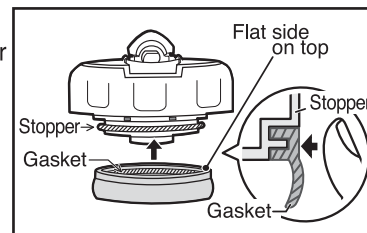

Replacing the Mouth Gasket:

If the mouth gasket comes off, push it in from the inside of the mouth gasket opening as illustrated.

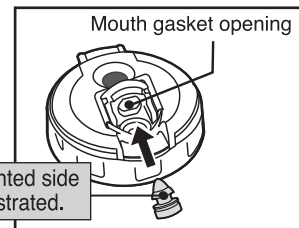

How to Clean:

Body and Outer Lid (Cup)

Wash with warm water, dishwashing soap and a soft cloth. Rinse and dry with a soft cloth or air dry.

Inside

Fill the bottle with warm soapy water using a brush to clean the inside. Rinse and dry with a soft cloth or air dry. To remove stains from coffee, tea or hard water buildup, use coffee cleaners sold in stores.

Caution:

- Make sure the stopper is screwed into the bottle completely before pouring liquids.
- Hot liquids will remain very hot for many hours. Please use caution when pouring or drinking.
- **DO NOT** clean the bottle with abrasives, bleach or cleansers containing chlorine.
- Avoid placing your bottle on top of or near extremely hot surfaces such as stoves, heaters, etc.
- **Please avoid filling the bottle with the following:**
 - ▷ Dry ice and carbonated drinks: contents may spill out or the pressure may cause the lid to burst, causing injuries.
 - ▷ Liquids with salt such as soup: although the liner is made of 18/8 stainless steel and is nonstick coated, salt may cause rust resulting in loss of thermal insulation.
 - ▷ Dairy products and fruit juice: if left inside for a long period of time, contents may spoil and produce gas that may cause the lid to burst, causing injuries.
 - ▷ Fruit pulp and tea leaves: may become caught in the stopper and cause contents to spill.
- Keep out of reach of infants to prevent scalding when the bottle contains hot liquids.



FULL FIVE YEAR WARRANTY

FULL FIVE YEAR WARRANTY FOR SJ-SDE

ZOJIRUSHI AMERICA CORPORATION ('ZOJIRUSHI') warrants only the thermal insulation of this product against defects for a period of five years from the date of original retail purchase. When returning the product, include your name, address, daytime telephone number, a description of the problem and a copy of the dated sales slip or receipt of purchase. No warranty work can be performed without all this information.

ZOJIRUSHI will replace a defective product at no charge, provided you return the product during the warranty period with transportation charges prepaid to ZOJIRUSHI. This warranty does not include any postage, freight, transportation, insurance or delivery fees. Do not return this product to the store from whom this was purchased.

PURCHASES MADE OUTSIDE OF THE U.S.A. MUST BE RETURNED TO THE PLACE OF PURCHASE DURING THE WARRANTY PERIOD.

Also this warranty does not apply if the product has been damaged by accident, abuse, misuse, or misapplication; has been altered or modified without the written permission from ZOJIRUSHI; has been serviced by a non-authorized service center; has not been properly maintained or operated according to the operation manual; has been used for commercial, non-household purposes; was not imported by ZOJIRUSHI; was not manufactured according to the specifications of the United States market; has been damaged by accidental, improper installation or neglect; or if the serial number on the product has been removed or defaced.

Properly pack the product (preferably in the original carton) so as to prevent damage to the product in transit. You may choose to insure the product but this is not required.

All repaired products shall be warranted for the remaining term of the original warranty.

ZOJIRUSHI IS NOT RESPONSIBLE OR LIABLE FOR ANY LOSS, INCONVENIENCE OR DAMAGE, WHETHER SPECIAL, DIRECT, INCIDENTAL, CONSEQUENTIAL OR OTHERWISE, AND WHETHER KNOWN OR SHOULD HAVE BEEN KNOWN TO ZOJIRUSHI, INCLUDING LOST PROFITS, GOODWILL, DAMAGE TO OR REPLACEMENT OF OTHER EQUIPMENT AND PROPERTY AND PERSONAL INJURY RESULTING FROM ANY BREACH OF WARRANTY, THE INABILITY TO USE THE PRODUCT OR UNDER ANY LEGAL THEORY IN CONTRACT OR TORT. THESE WARRANTIES AND REMEDIES ARE YOUR SOLE AND EXCLUSIVE WARRANTIES AND REMEDIES IN CONNECTION WITH THE SALE AND USE OF THE PRODUCT. NO OTHER WARRANTIES, ORAL OR WRITTEN, EXPRESS OR IMPLIED, ARE GIVEN. ZOJIRUSHI'S LIABILITY IS LIMITED TO THE ACTUAL PURCHASE PRICE YOU PAID TO THE RETAIL SELLER OF THE DEFECTIVE PRODUCT.

Some states do not allow the exclusion or limitation of implied warranties or liability for incidental or consequential damages, or do not allow a limitation on how long an implied warranty lasts, so the above limitations or exclusions may not apply to you. You are advised to contact applicable state laws for a full determination of your rights. This warranty gives you specific legal rights, and you may have other rights which vary from state to state.

No dealer, agent or employee is authorized to make any modification, extension, change or amendment to this warranty.

For questions or comments, please contact:

Zojirushi America Corporation

Tel: 800- 733-6270

www.zojirushi.com

