

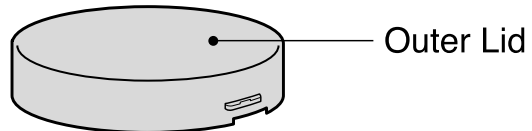

Thank you for your purchase of this quality Zojirushi product. We are confident that it will give you top performance and optimum satisfaction for many years. To ensure this, please read and follow the important guidelines below.

Name of Each Part

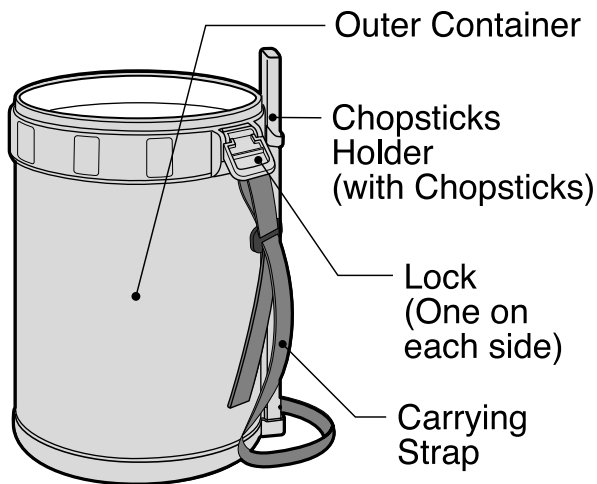

Side Bowl Set

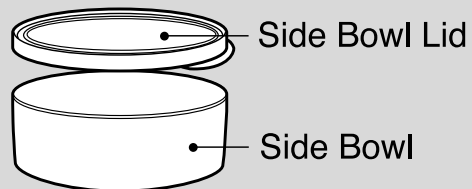

Main Bowl Set

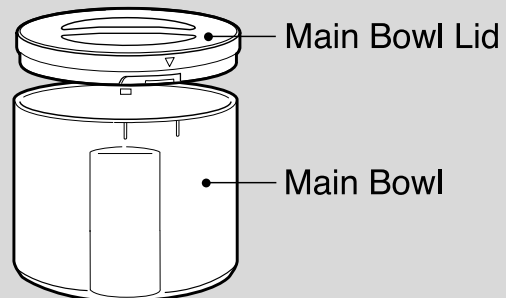

Soup Bowl Set

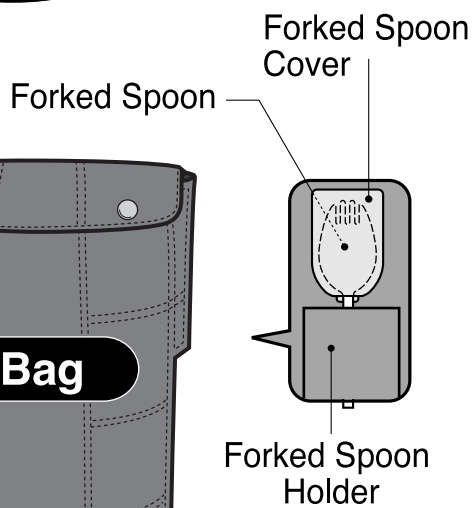
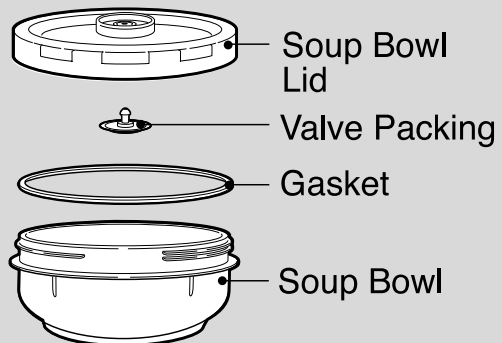

● Be sure that all parts are attached firmly before each use.

*Please place Inner Bowls in the following order: Soup Bowl→Main Bowl→Side Bowl

● The illustrations used in this instruction manual may vary from the actual product you have purchased.

HOW TO REMOVE/ATTACH THE GASKET

To Remove: Remove the gasket from the inside by using a pin or a small object and fitting it into the small opening.

To Attach:

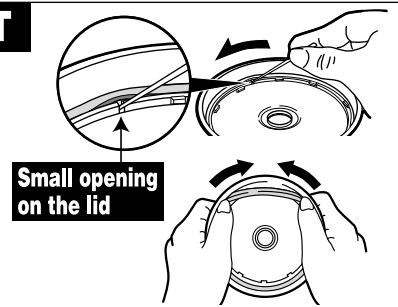

The valve packing is located at the center of the soup bowl lid. To remove, pull the valve packing with your fingers as illustrated.

*Be sure to place the valve packing after cleaning.

*Please take caution not to damage the valve packing with your fingernails wh

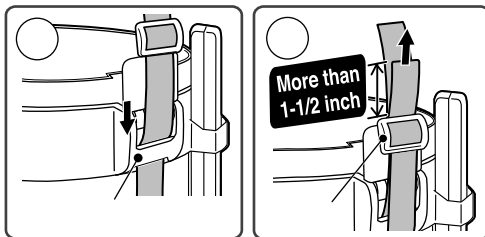

To Remove:

Remove the chopsticks holder as illustrated.

To Attach:

Put the chopsticks holder through the opening as illustrated until it clicks.

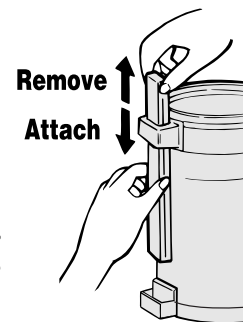

CAUTIONS

- Keep out of the reach of infants and small children. Do not allow them to play with this product. They may scald or otherwise injure themselves.
- Keep away from heat sources such as gas stoves, ovens and heaters. Doing so may cause deformation or discoloration.
- When placing inner bowls in the microwave, please:
 - *Remove all lids from the inner bowls. The lids are not microwave safe.
 - *Do not microwave the outer container. Doing so may produce sparks and be dangerous.
 - *Do not microwave the inner bowls when there is nothing inside. Doing so may deform the bowls.
- Do not leave the lunch jar on its side (contents may spill).
- Do not leave food in the lunch jar for a long period of time for it may spoil. Do not include foods that spoil easily such as raw foods and dairy products. The pressure of the gas created by spoiled food may damage or deform the container.
- Please avoid storing liquids in the main bowl or side bowl for it may spill.
- Do not place any food directly in the outer container. Doing so may cause the container to rust.
- Clean the inside of the outer container to prevent from rusting.
- Do not carry by the lid.
- Avoid dropping or hitting against hard surfaces.
- Consume foods within 6 hours to keep foods from spoiling.
- Cool foods to room temperature when storing in the side bowl. Closing the side bowl lid while the content is hot may cause deformation or cause contents to spill.
- Do not place the main bowl containing hot food (or cold food) and the soup bowl containing cold food (or hot food) together in the outer container, or do not put hot food and cold food in one bowl at the same time.
- Always clean the container and gasket thoroughly after use. Not doing so may cause decay, mold, odor, or discoloration. It may also cause leaks.
- Do not attach parts other than those specifically for this product. Doing so may cause leaks or breakage.
- The rattling noise that may be heard when the outer body is shaken comes from the copper or aluminum foil in the vacuum insulation to increase heat (cold) retention and does not indicate a malfunction.
- Do not store rice cooked with additional ingredients and seasonings such as mixed rice or fried rice. Doing so may lead to spoiling.
- The lunch jar may not sufficiently keep the content warm if the lunch jar is used without hot soup put into the soup bowl. The heat retention effect of the lunch jar will be enhanced if hot water is put into the soup bowl if no soup needs to be kept warm.

HOW TO TAKE CARE OF YOUR LUNCH JAR Be sure to clean after each use.

Outer Lid / Side Bowl Set Main Bowl / Soup Bowl Set Forked Spoon Cover Chopsticks Holder Chopsticks	Wash with warm water and mild dishwashing liquid, rinse and dry. *Remove and wash the gasket and valve packing after each use. *Remember to place the gasket and valve packing after washing. *Remove the lid while drying.
Outer Container Main Bowl Lid Forked Spoon	Wash with warm water and mild dishwashing liquid, rinse and dry with a soft cloth.
Bag Carrying Strap	Wipe clean with a well wrung soft cloth soaked in mild dishwashing liquid and warm water.

- *Do not place in dishwashers or dryers. Doing so may cause scratches or rust, deformation or malfunction of the lunch jar.
- *Do not clean with thinner, benzene, abrasive cleaners or other harsh cleaners. Doing so may damage the lunch jar.
- *Do not use chlorine type bleach. Doing so may cause rust and pinholes of the outer container and compromise its heat retention properties.

REPLACEMENT PARTS

We take care in only using materials that are safe and hygienic for food contact. However, if plastic parts become damaged or its surface becomes rough, please replace them for optimum performance. The valve packing and gaskets may need to be replaced due to time and wear. Please check them about once a year. When replacing parts, please record the model number and part name beforehand. Then contact either the store where you purchased the product or Zojirushi Customer Service. Replacement parts may be available for an additional charge.

■ Valve Packing (Part No.: 561656)

■ Gasket (Part No.: 561657)

For questions or comments, please contact: **Zojirushi America Corporation**
Tel: (800)733-6270 / www.zojirushi.com