

Thank you for your purchase of this quality Zojirushi product. We are confident that it will give you top performance and optimum satisfaction for many years. To ensure this, please read and follow the important guidelines below.

### Name of Each Part:

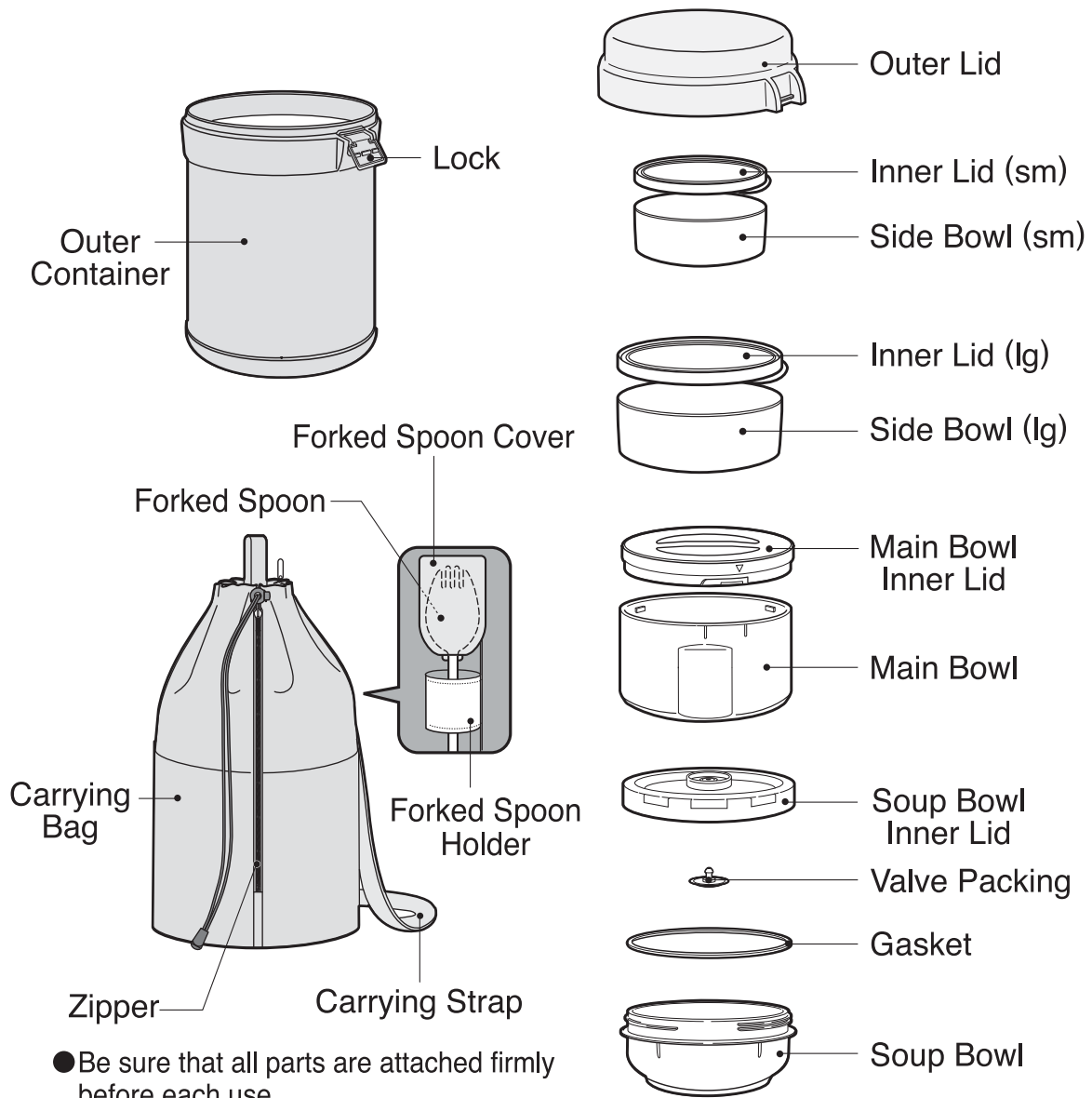

● Be sure that all parts are attached firmly before each use.

\* Please place inner bowls in the following order:  
 Soup Bowl → Main Bowl → Side Bowl (lg) → Side Bowl (sm)

SL-JAE (E/T/K/J) / E

## How to Use:

### 1. Remove inner bowls

Unlock the sides, remove outer lid, and take out inner bowls from outer container.



### 2. Preheat (Precool)

- a. For maximum heat (cold) retention, fill outer container, main bowl and soup bowl with hot water (cold water) for 1-2 minutes.
- b. After preheating (precooling), discard the hot water (cold water) and wipe with soft cloth.

### 3. Fill soup bowl

Fill the soup bowl with hot (cold) soup, close the inner lid tightly and place in the outer container.

### 4. Fill main bowl

Fill the main bowl with hot (cold) food, close the inner lid and place in the outer container.

\* When closing the inner lid, make sure the triangle mark on the lid aligns with the tab mark.

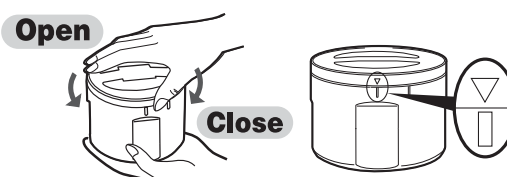

### 5. Fill the side bowls

Fill the side bowls and close the inner lid. Place in the outer container.



### 6. Lock the lid on the outer container and place in carrying bag

\* Place the forked spoon in the forked spoon holder of the carrying bag.

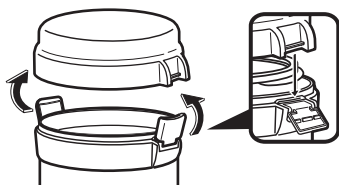

Product Name	Stainless Lunch Jar
Model No.	SL-JAE14
Capacity	Main Bowl 15.2 oz. (0.45L) Side Bowl(lg) 10.1 oz. (0.3L) Side Bowl(sm) 6.8 oz. (0.2L) Soup Bowl 9.5 oz. (0.28L)

## How to Remove/Place the Gasket and Valve:

### Gasket

**a. To Remove:** Remove the gasket from the inside by using a pin or a small object and fitting it into the small openings.



**b. To Place:** Fit the gasket around the inside of the inner lid by pushing it in with your fingers.

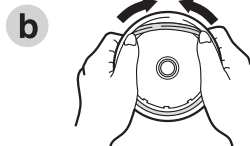

### Valve Packing

The valve packing is on the center of the inner lid. To remove, pull the valve packing off with your fingers. Please replace the valve packing after cleaning. Please take caution not to scratch the valve with your fingernails.

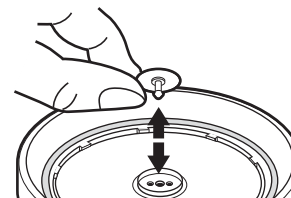

### Cautions:

- Keep out of the reach of infants and small children. Do not allow them to play with this product. They may scald or otherwise injure themselves.
- Keep away from heat sources such as gas stoves, ovens and heaters.
- When placing inner bowls in the microwave, please:
  - Remove all lids from inner bowls.
  - Do not microwave outer container.
  - Do not microwave the inner bowls when there is nothing inside.
- Do not leave the lunch jar on its side (contents may spill).
- Do not leave food in lunch jar for a long period of time for it may spoil. Do not include foods that spoil easily such as dairy products.
- Please avoid storing liquids in the main bowl or side bowls for contents may spill.
- Do not place any food directly in the outer container.
- Clean the inside of the outer container to avoid rusting.
- Do not carry by the lid.
- Avoid dropping or hitting against hard surfaces.
- Consume foods within 6 hours to keep foods from spoiling.
- Cool foods before storing in the side bowls to prevent from spoiling. Closing the lid while the content is hot may deform the lid and cause spilling.
- Do not put hot food and cold food in the main bowl and soup bowl, or hot food and cold food in one bowl at the same time (contents may spoil).
- Always clean the container and gasket thoroughly after use. Not doing so may cause decay, mold, odor, or discoloration. It may also cause leaks.
- Do not attach parts other than those specifically for this product. Doing so may cause leaks or breakage.
- The rattling noise that may be heard when the outer body is shaken comes from the copper or aluminum foil in the vacuum insulation to increase heat (cold) retention and does not indicate a malfunction.

## Cautions: cont.

- Do not store rice cooked with additional ingredients and seasonings such as mixed rice or fried rice. Doing so may lead to spoiling.
- The lunch jar may not sufficiently keep the content warm if the lunch jar is used without hot soup put into the soup bowl. The heat retention effect of the lunch jar will be enhanced if hot water is put into the soup bowl if no soup needs to be kept warm.

## How to Take Care of your Lunch Jar:

<b>Outer Lid</b> <b>Inner Bowls</b> <b>Forked Spoon Cover</b>	Wash with warm water and mild dishwashing liquid, rinse and dry. <ul style="list-style-type: none"><li>• Remove and wash the gasket and valve after each use.</li><li>• Remember to replace the gasket and valve packing after washing.</li><li>• Remove lid while drying.</li></ul>
<b>Outer Container</b> <b>Inner Lids</b> <b>Forked Spoon</b>	Wash with warm water and mild dishwashing liquid, rinse and dry with a soft cloth. <ul style="list-style-type: none"><li>• Do not soak.</li></ul>
<b>Carrying Bag</b>	Wipe with a damp cloth with warm water and mild dishwashing liquid.

## For Odor Problems:

If the jar is kept unwashed for a long period of time or is not cleaned thoroughly, the inner bowls may smell or discolor. In this case, please follow these instructions.

<b>Outer Container</b> <b>Inner Bowls</b>	Wash thoroughly and dry with a soft cloth. Place in the sun and let dry for 1-2 hours.
<b>Soup Bowl</b>	Boil the inner bowl for 2-3 minutes in hot water and dry as directed above.

- \* Do not soak.
- \* Do not place in dishwashers or dryers.
- \* Do not clean with thinner, benzene, abrasive cleaners or other harsh cleaners.
- \* Do not use chlorine type bleach.

## Replacing the Valve Packing and Gasket

We take care in only using materials that are safe and hygienic for food contact. However, if plastic parts become damaged or its surface becomes rough, please replace them for optimum performance. The Valve Packing and Gasket may need to be replaced due to time and wear. Please check them about once a year. When replacing parts, please record the model number and part name beforehand. Then contact either the store where you purchased the product or Zojirushi Customer Service. Replacement parts may be available for an additional charge.

For questions or comments, please contact: **Zojirushi America Corporation**  
Tel: (800)733-6270 / [www.zojirushi.com](http://www.zojirushi.com)