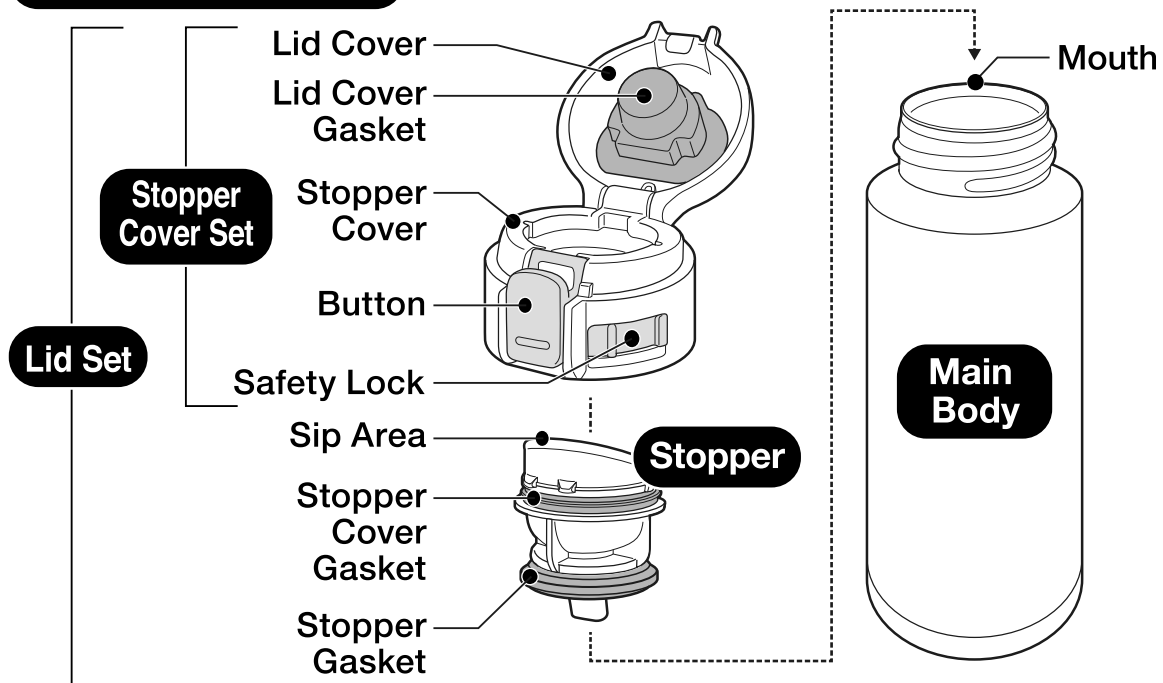

STAINLESS MUG
Model SM-P
Instruction Manual
Name of Each Part

- The illustrations used in this instruction manual may differ from the actual product you have purchased.
- Please read these instructions before use, and keep for future reference.

Warning

- **Please follow these instructions to prevent injury, scalding, accidents, malfunction or performance deterioration of the product, spilling of beverages, etc.**

Do not allow infants or small children to use this product. Keep out of the reach of infants and small children.

Do not attach parts other than those specifically designed for this product.

Always make sure that the parts are attached during use.

Do not use the product if its thermal insulation performance has deteriorated.

When containing hot beverages:

- Drink slowly without tilting the product suddenly.
- The pressure inside the product may rise, making it difficult to remove the Lid Set. If that happens, open the Lid Cover once, and remove the Lid Set.

SM-P-4C (E/K/T/C) / A

Do not use if water enters the interior of the Vacuum Layer.

If the internal water seeps out from the Vacuum Layer, drinking it may cause illness.

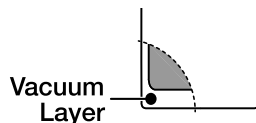

Leave 1cm (1/2-inch) room on top when filling the Main Body.

Leave 1cm (1/2-inch) space below the rim (part A)

Inside of the Main Body

Drink Level

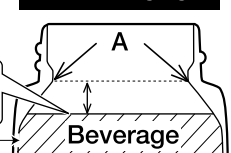

Do not use this product for other than storing and keeping beverages hot or cold.

Do not hold the product by the Lid Set or the Lid Cover when carrying because the product may fall and cause injuries.

Make sure that there is no beverage leakage before using the product.

Avoid dropping or hitting against hard surfaces.

Do not disassemble the product (other than parts designed to be disassembled).

Do not heat in a microwave, as doing so may cause sparks.

Do not place near open flames (from gas stoves, etc.), on top of electric heaters, or IH cooking devices, as doing so may cause a fire or malfunction.

Never remove the sticker on the bottom of the Main Body.



Thoroughly clean the inside and outside of the Main Body (mouth) and the Stopper and Gaskets after every use. Be particularly careful after filling the product with sports drinks.

When pouring hot beverages into the Main Body, be careful not to let it tip over.

Do not open the Lid Cover with the product close to your face or tilted toward you.

Do not drink out of the product while driving.

When a vehicle drink holder is available:

- Make sure that the product sits securely inside the drink holder.
- Do not use a hanging-type drink holder that attaches to the window or air vent.

Consume beverages within the same day.

Spoiled beverages may produce gas, raising the pressure inside the product and causing the Lid Set to burst.

Never fill the product with the following:

- Dry ice or carbonated drinks
- Liquids high in sodium such as soup or Kobu-cha
- Dairy products or fruit juice
- Fruit pulp or tea leaves

Do not fill the product with the Lid Set attached, as it may overflow.

Do not place near heat sources such as gas stoves, ovens, and heaters, as doing so may cause deformation or discoloration of the product.

Break ice cubes into smaller pieces, as failure to do so may cause deformation of the Main Body and leakage.

Place the product vertically when carrying it in a bag to prevent leakage or condensation.

This product is designed to be drunk directly, so the beverage may splash if it is used for pouring.

Do not scratch or rub the design on the outside of the Main Body strongly using fingernails or hard objects, as this may cause the design to come off.

Note: The rattling noise that may be heard when the Main Body is shaken comes from the metallic foil used in the vacuum insulation to increase heat (cold) retention, and does not indicate a malfunction.

How to Use:

- Follow the instructions for care and wash the product thoroughly before use.
- When you first use the product, there may be a plastic smell. However, this will become less noticeable with use.

Locking and Unlocking the Safety Lock

- Close the Lid Cover and lock.
- Do not close the Lid Cover when the Safety Lock is locked.

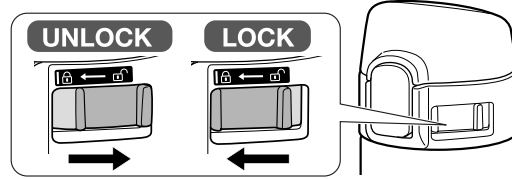

Opening and Closing the Lid Cover

- How to open



- How to close

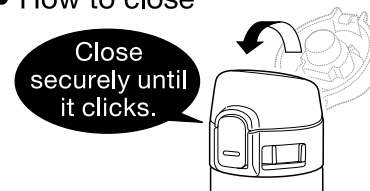

How to Disassemble the Lid Set:

1 Remove the Stopper.

With the Lid Cover open, hold the Lid Set and press on the back of the Sip Area (parts indicated by the ↓ marks) to remove the Stopper.

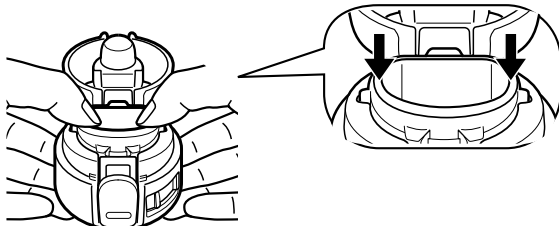

2 Remove the Stopper Gasket.

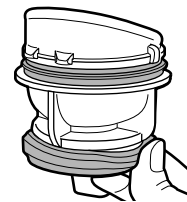

3 Remove the Stopper Cover Gasket.

Place your finger in the small opening on the Stopper and gently pull the Stopper Cover Gasket off while being careful not to damage it.

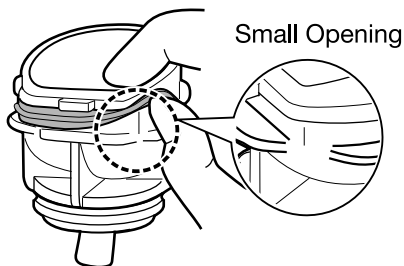

4 Remove the Lid Cover Gasket.

Pinch the edge of the Lid Cover Gasket and pull it toward you to remove.

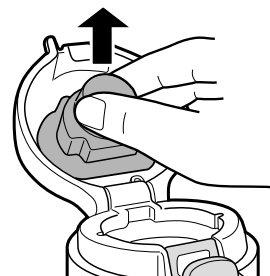

How to Assemble the Lid Set:

1 Attach the Lid Cover Gasket.

Align the Small Opening on the Stopper Cover Gasket with the protrusion on the Lid Cover.

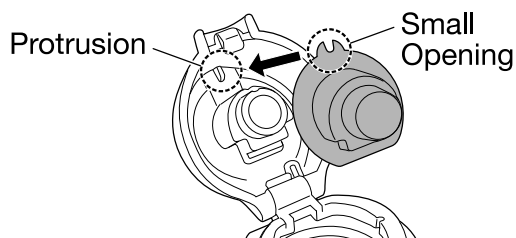

2 Attach the Stopper Cover Gasket.

Attach the Stopper Cover Gasket with the ridge facing out.

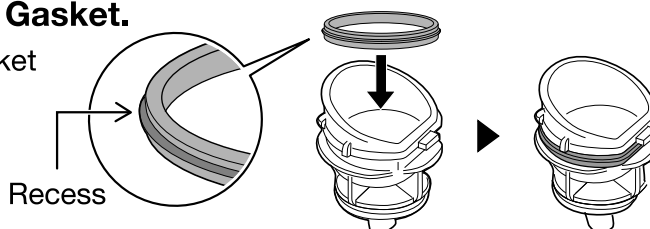

3 Attach the Stopper Gasket.

Line up the recess in the Stopper Gasket with the ridge on the Stopper, and, firmly applying pressure from the outside, push it into place.

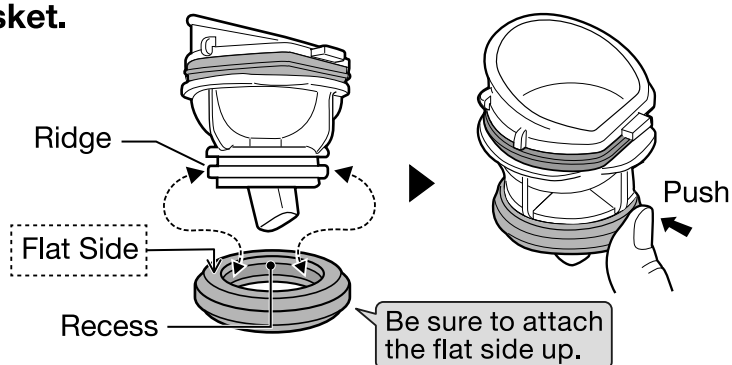

4 Attach the Stopper.

Align the opening of the Stopper Cover Set and the tab of the Stopper, and press the Stopper in to attach it.

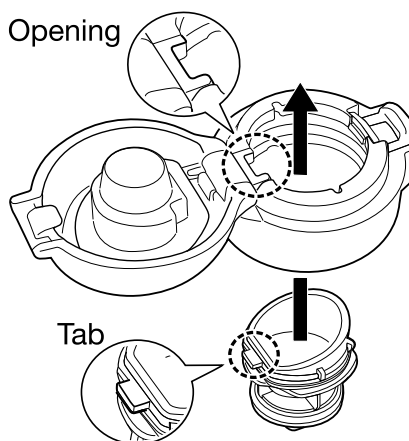

How to Take Care of Your Product:

- Clean the product after each use to prevent odors and mold, and to keep the product sanitary.
- Always disassemble the product before cleaning.

When Cleaning Your Product:

- Do not boil or use a dishwasher or dish-dryer.
- Do not clean using paint thinner, polishing powders, abrasive cleansers, scrub brushes (nylon, metal wire, etc.), melamine sponges, the nylon side of an abrasive sponge, or any similar items.
- Do not use bleach as it may damage the product.
Zojirushi's designated cleaning detergent SB-ZA01/SB-ZA01E may be used to clean the interior of the Main Body and the Lid Set.
- The Main Body is fully washable, but do not soak it in water for an extended period of time.
- If the product is not going to be used for an extended period, wash thoroughly and dry well. Store the product away from high temperatures and humidity.

Regular Care

- ① Using warm water and mild dishwashing liquid, wash the Lid Set and the outside of the Main Body with a sponge and the inside of the Main Body with a soft sponge with a handle.
Use a small brush if necessary.
 - ② Rinse, wipe away remaining water, and leave to dry thoroughly.
- Streaks or smudges caused by rubbing on the coated portion of the Main Body can be removed using a soft eraser.

Dealing with Stubborn Dirt

Rust Spots and Water Stains	<ol style="list-style-type: none">① Fill the Main Body with hot water with 10% vinegar without attaching the Lid Set.② After 30 minutes to an hour, wash the interior thoroughly.
Tea and Coffee Stains	Remove the Lid Set and use Zojirushi's cleaning detergent SB-ZA01/SB-ZA01E. (Contact Zojirushi Customer Service or your local dealer for further information.)

Replacing the Stopper and Gaskets:

We take care in only using materials that are safe and hygienic for food contact. However, if plastic parts become damaged or their surface becomes rough, please replace them for optimum performance. The Stopper and other consumable parts may need to be replaced due to time and wear. Please check them about once a year. When replacing parts, please record the model number and part name beforehand. Then contact either the store where you purchased the product or Zojirushi Customer Service. Replacement parts may be available for an additional charge.