



Household Use Only

## STAINLESS MUG SM-SA / SM-SC

## Instruction Manual

### Name of Each Part

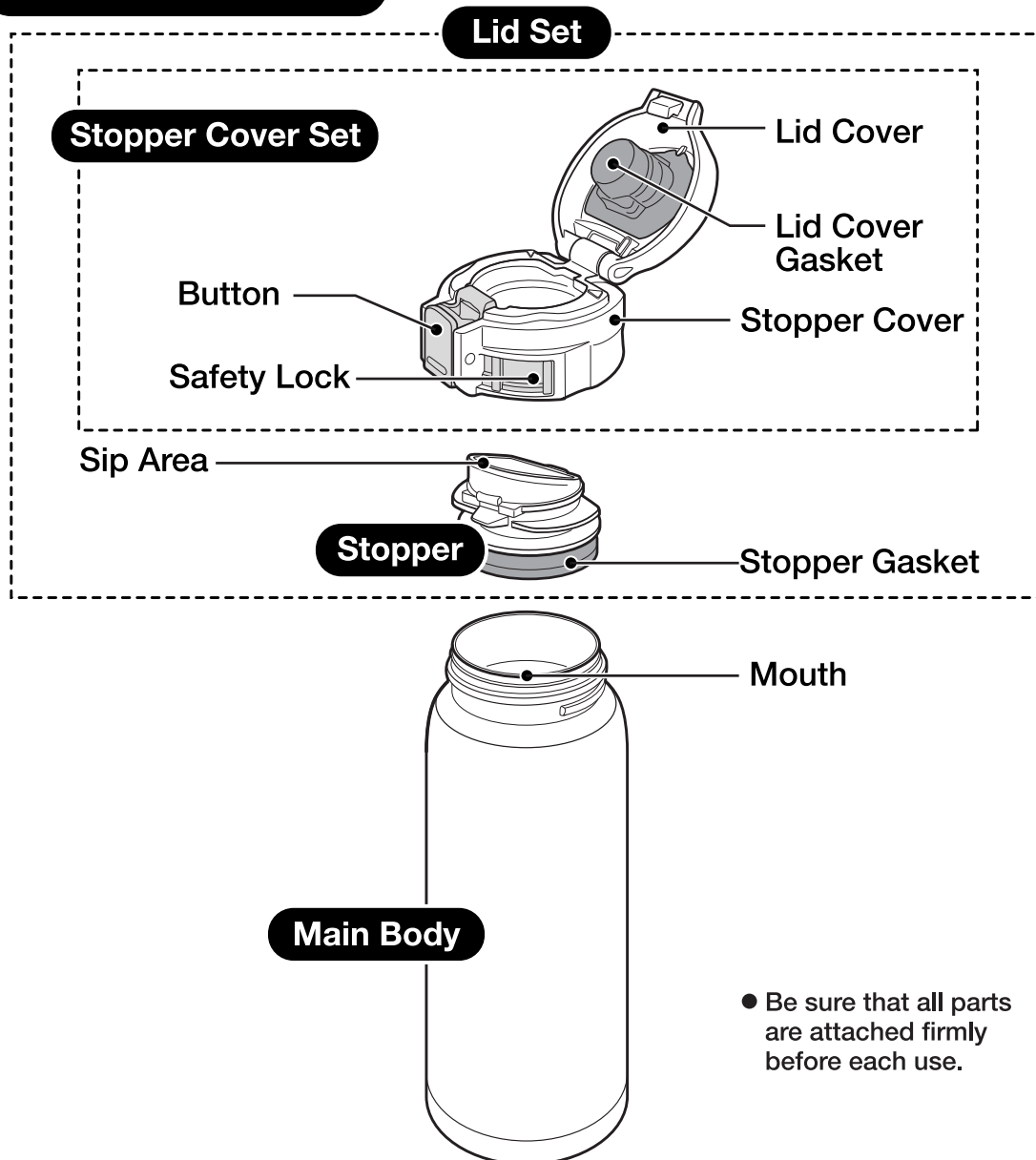

- Be sure that all parts are attached firmly before each use.

● The illustrations used in this instruction manual may differ from the actual product you have purchased.

Please read these instructions before use, and keep for future reference.

SM-SA / SM-SC (E/K) / D

# Important Safeguards

- Please follow these instructions to prevent scalding, deterioration and discoloration of beverages, as well as malfunction and staining of the Mug.

<b>Do not allow infants or small children to use this product. Keep out of the reach of infants and small children.</b> Mishandling may cause injury or scalding.	<b>Do not use if the Mug loses its heat retention properties.</b> The outside of the Main Body may become very hot if hot beverages are poured inside.
<b>Always make sure that the Lid Cover Gasket and Stopper Gasket are attached during use.</b> Contents may leak and/or cause scalding.	<b>Do not open the Lid Cover with the Mug close to your face or tilted toward you.</b> Hot beverages may suddenly come out or spew out and may cause scalding.
<b>Do not fill with beverages while the Lid Set is attached.</b> Doing so may cause beverages to overfill and may cause burning and scalding.	<b>Do not heat in a microwave.</b> Doing so may cause sparks, deformation or discoloration of the Mug.
<b>Be sure to set the Lid Set and close the Lid Cover securely after use.</b> Contents may leak and/or cause scalding.	<b>Do not drink out of the Mug while driving. Always close the Lid Set securely after drinking.</b> Doing so may cause scalds or stain the interior of the car or clothes. Attempting to use while driving may also cause serious accidents.

## When containing hot beverages:

- **Drink slowly without tilting the Main Body suddenly.**  
There is a possibility that the beverage may spill and cause burns.
- **Do not shake the Mug.**  
Doing so may cause scalds or injury.
- **Be careful not to scald yourself when drinking out of the Mug.**  
Due to its vacuum insulation, the outside of the Mug will not become hot, while the beverages inside will remain very hot for many hours. Please drink with caution.
- **The pressure inside the Main Body may rise, making it difficult to remove the Lid Set. If that happens, open the Lid Cover once, and remove the Lid Set.**  
Forcibly removing the Lid Set may make it fly off abruptly, causing injuries or burns.

## Do not fill the Mug with the following:

- **Dry ice and carbonated drinks:** Contents may spill out or the pressure may cause the Lid Set to burst, causing injuries.
- **Liquids high in sodium such as soup and Kobu-cha:** Although the liner is made of 18/8 stainless steel and is nonstick coated, salt may cause rust resulting in loss of thermal insulation.
- **Dairy products and fruit juice:** If left inside for a long period of time, contents may spoil and produce gas that may cause the Lid Set to burst, causing injuries.
- **Fruit pulp and tea leaves:** May become caught on the Stopper Gasket and cause contents to spoil.

## Important Safeguards continued

- Please follow these instructions to prevent scalding, deterioration and discoloration of beverages, as well as malfunction and staining of the Mug.

### Do not disassemble the Main Body.

#### Consume beverages within the same day.

Not doing so may cause spoiling. In addition, if left inside for a long period of time, spoiled beverages may produce gas, raising the pressure inside the Main Body and causing the Lid Set to burst or beverages to spill, resulting in injuries and scalding.

### Do not place near heat sources such as gas stoves, ovens and heaters.

Doing so may cause deformation or discoloration of the Mug.

### Do not remove the sticker on the bottom of the Main Body.

Doing so may cause rust or holes.

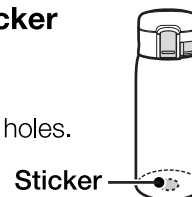

### Leave 1cm (1/2-inch) room on top when filling the Main Body.

Contents may overflow when placing the Lid Set.

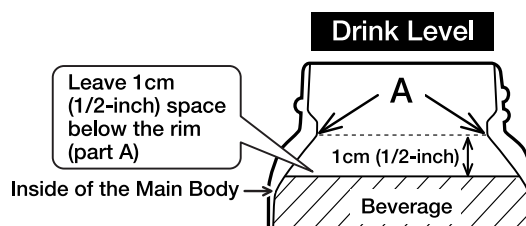

### When using a vehicle cup holder accessory:

- ① **Always keep the Lid Cover securely closed when not drinking.**  
Beverage may spill if the Mug is tipped over, causing scalds or injury.
  - ② **Make sure the Mug fits into the holder securely before placing it in.**  
Do not use the Mug if it does not fit into the holder securely as it may tip over and cause scalds, injury or accidents.
  - ③ **Check that the strength of the cup holder is sufficient to hold the Mug before using.**  
The Mug may fall and cause injuries or burns, or stain the interior of the car or clothes if the cup holder does not hold up.
  - ④ **Do not use a hanging-type cup holder that attaches to the window or air vent.**  
The cup holder may fall off.
- **The Mug may not fit into some cup holders.**

### When filling the Mug with sports drinks:

- In order to prevent rusting and/or pinholes, rinse the inside and outside of the Main Body and the Lid Set immediately after consumption.
- Clean the inside using a soft sponge to protect the nonstick coating from getting scratched.

## Important Safeguards continued

- Please follow these instructions to prevent scalding, deterioration and discoloration of beverages, as well as malfunction and staining of the Mug.

### Clean the Main Body after every use.

Not cleaning thoroughly may cause the Main Body to rust, beverages to spoil, or cause pinholes.

### This Mug is for storing and keeping beverages hot or cold.

**Please do not use for other than intended purposes.**

## Warnings & Cautions

### Do not allow hot kettles to touch the Mouth of the Main Body.

The Mug may tip over, causing scalds.

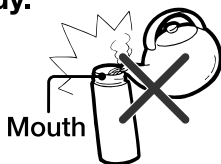

### Do not leave a tea bag inside and set the Lid Set.

The tea bag may swell and cause leakage or cause drinks to spill out.

### Do not force large ice cubes in. Break them into smaller pieces instead.

Doing so may cause deformation or damage to the product.

### Avoid dropping or hitting against hard surfaces.

Damage to the plastic or stainless steel surface of the Mug may reduce its ability to retain heat.

### Do not hold the Mug by the Lid Set or the Lid Cover when carrying.

The Mug may fall and cause injuries.

### Hot tea may discolor if stored for a long period of time. We recommend the use of tea bags and brewing right before consumption.

### Always clean the Lid Set, Lid Cover Gasket and Stopper Gasket thoroughly after use.

Not doing so may cause decay, mold, odor or discoloration. It may also cause leaks.

### Do not scratch or rub the design on the outside of the Main Body strongly using fingernails or hard objects.

This may cause the design to come off.

### Do not attach parts other than those specifically designed for this product.

Doing so may cause leaks or breakage.

Placing ice cubes in the Mug may cause the internal pressure to decrease and the Lid Cover Gasket may come off when opening the Lid Cover. If this happens, please reattach the Lid Cover Gasket.

If a cold beverage is put into the product under highly humid conditions, condensation may form on the Lid Set. Stand the product upright when placing in bags.

### Always disassemble the Lid Set when washing and wipe dry (see pg.7).

Water may drip out if it is not dried well.

The rattling noise that may be heard when the Main Body is shaken comes from the copper or aluminum foil in the vacuum insulation to increase heat (cold) retention and does not indicate a malfunction.

# How to Use:

- Follow the instructions for care and wash the Lid Set, the inside and outside of the Main Body thoroughly before use.

## 1 Remove the Lid Set from the Mug.

Remove the Lid Set from the Mug by turning it counterclockwise as illustrated.

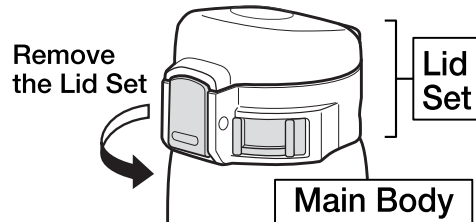

## 2 Fill the Mug with beverage.

For better heat retention, preheat or precool the Main Body with hot water (cold water) for about one minute, and then fill it with your beverage.

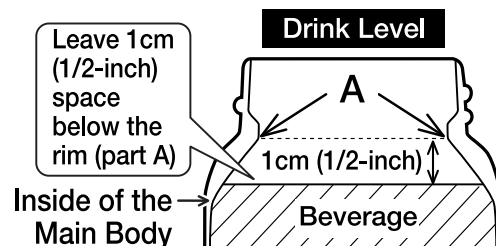

## 3 Set the Lid Set securely.

Close the Lid Cover, lock the Safety Lock\* then turn the Lid Set clockwise as illustrated to set.

\*See illustration for “4” below.

- Confirm that the Stopper Gasket and Lid Cover Gasket are correctly attached before using. (If not correctly attached, the beverage may leak.)
- Firmly attach the Lid Set to the upright Main Body, lining up the Zojirushi logo mark with the center of the Lid Set.
- Attach the Lid Set properly and turn the Mug upside down to make sure contents do not leak.

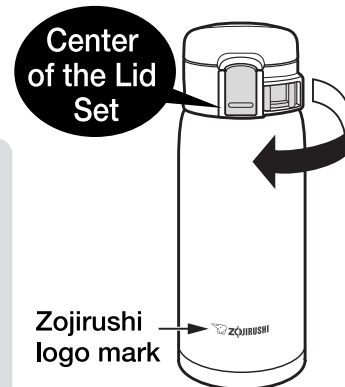

## 4 Unlock the Safety Lock.

Slide the Safety Lock to the right (🔓) to unlock.

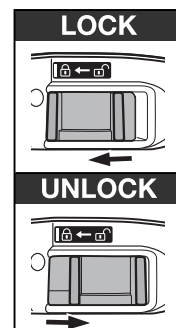
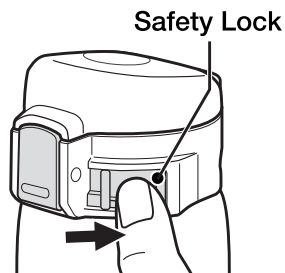

## How to Use: continued

- Follow the instructions for care and wash the Lid Set, the inside and outside of the Main Body thoroughly before use.

### 5 Open the Lid Cover.

Push the Button and release to open the Lid Cover.

The Lid Cover may open slightly.



Opens

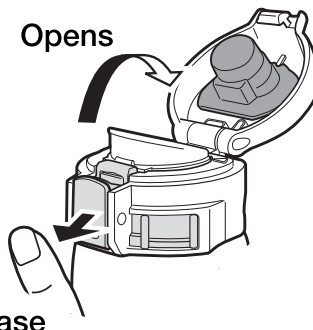

### 6 Drink the beverage.

- Do not tilt the Mug suddenly when drinking. (The beverage may spill and cause scalding or stain clothes.)

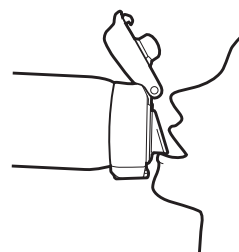

### 7 Close the Lid Cover and lock.

- ① With the Mug at an upright position, close the Lid Cover until it clicks.
- ② Slide the Safety Lock to the left to lock (see pg.5 illustration "4").

Close securely until it clicks.

- Do not leave the Mug with the Lid Cover open.
- Always close the Lid Cover securely at an upright position.

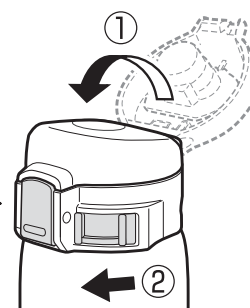

- Store the Mug upright when carrying inside bags to prevent beverages from spilling.



# How to Disassemble & Assemble the Lid Set:

- Be sure to attach the Stopper Cover Set, Lid Cover Gasket, Stopper and Stopper Gasket correctly to prevent malfunction or leaking of beverages.

## How to Disassemble:

**1 Remove the Lid Set from the Mug.**

**2 Remove the Stopper.**  
With the Lid Cover open, hold the Lid Set as illustrated, and press on the back of the Sip Area (parts indicated by the ▽ marks) to remove the Stopper.

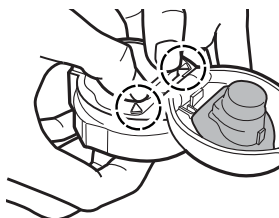

**3 Remove the Stopper Gasket.**

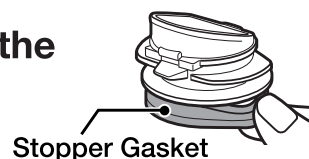

**4 Remove the Lid Cover Gasket.**

Pinch the edge of the Lid Cover Gasket as illustrated and pull it toward you to remove.

Lid Cover Gasket

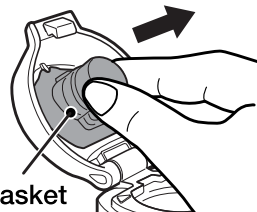

## How to Assemble:

**1 Attach the Stopper Gasket.** Fit the Stopper Gasket to the Stopper as illustrated.

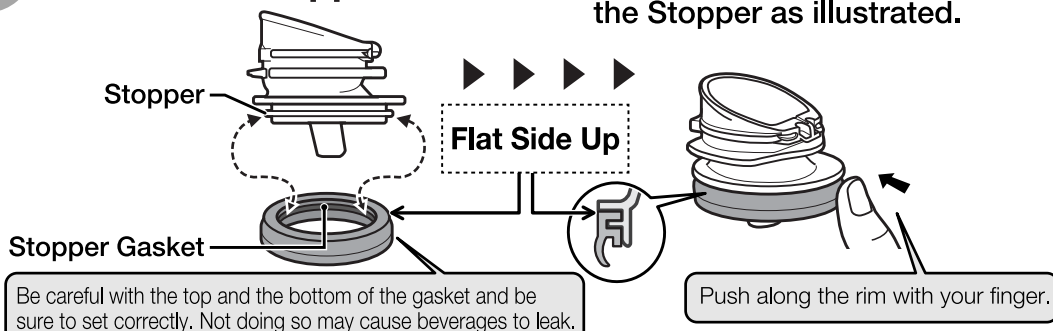

**2 Attach the Lid Cover Gasket.**  
Align the Small Opening on the Lid Cover Gasket with the protrusion on the Lid Cover and press to attach.

- Be sure to set the Lid Cover Gasket before use.

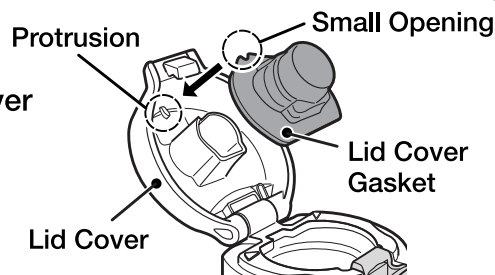

## How to Disassemble & Assemble the Lid Set: continued

### 3 Attach the Stopper.

Align the opening of the Lid Cover Set and the tab of the Stopper, and press the Stopper in to attach securely.

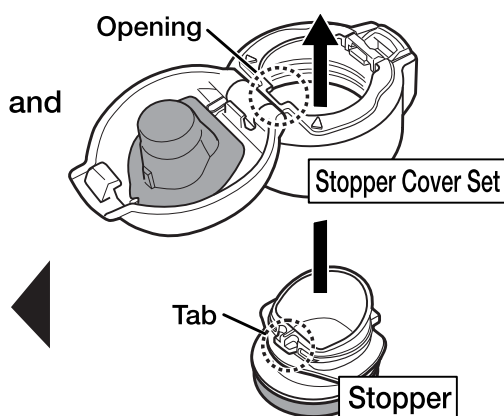
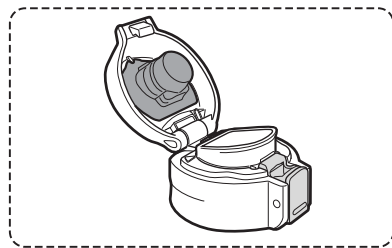

## How to Take Care of Your Mug:

- Clean the product after each use to prevent odors and mold, and to keep the product sanitary.

- Always disassemble the product before cleaning. (see pg.7)

### Exterior Lid Set

① Wash with warm water and mild dishwashing liquid using a soft sponge.

② Rinse, shake a few times and wipe dry.

- Disassemble the Lid Cover Gasket and Stopper Gasket before washing the Lid Set.

- When washing the Lid Set, disassemble it first then wash and dry.

- Use a small brush sold in stores if necessary.

### Interior

① Wash with warm water and mild dishwashing liquid using a soft sponge with handle.

② Then rinse and wipe moisture out to dry.

## When Cleaning Your Product:

**To protect the paint, print or stickers on the outside of the Main Body:**

- Do not use a dishwasher or dish-dryer. Do not boil to sanitize.

- Do not use bleach on the outside of the Main Body.

- Do not clean with thinner, benzene, abrasive cleaners or other harsh cleaners.

- Do not use chlorine type bleach.

- Do not soak in water for an extended period of time.

- Wipe moisture off thoroughly to prevent water stains or rusting.



## How to Take Care of Your Mug: continued

- Clean the product after each use to prevent odors and mold, and to keep the product sanitary.

### To Remove Rust Spots and Water Stains:

You may find rust spots or water stains caused by impurities in the water. To remove these stains, fill the Main Body with hot water with 10% vinegar and let it stand for 30 minutes to an hour without attaching the Lid Set, then wash the interior thoroughly.

### To Remove Coffee and Tea Stains:

To remove coffee and tea stains from the interior and the Lid Set, we recommend using Zojirushi's cleaning detergent SB-ZA01/SB-ZA01E. Always remove the Lid Set when using SB-ZA01/SB-ZA01E. Contact Zojirushi Customer Service or your local dealer for further information.

### Replacing the Lid Cover Gasket, Stopper or Stopper Gasket:

We take care in only using materials that are safe and hygienic for food contact. However, if plastic parts become damaged or its surface becomes rough, please replace them for optimum performance. The Stopper may need to be replaced due to time and wear. Please check them about once a year. When replacing parts, please record the model number and part name beforehand. Then contact either the store where you purchased the product or Zojirushi Customer Service. Replacement parts may be available for an additional charge.

## SPECIFICATIONS:

### Product: STAINLESS MUG

Model No.	Capacity	Weight	Heat Retention (Above)	Cold Retention (Below)
SM-SA36 SM-SC36	0.36 liter (12 oz.)	0.17 kg (6 oz.)	86°C (187°F) @ 1 hr. / 67°C (153°F) @ 6 hrs.	9°C (48°F) @ 6 hrs.
SM-SA48 SM-SC48	0.48 liter (16 oz.)	0.205 kg (8 oz.)	87°C (189°F) @ 1 hr. / 71°C (160°F) @ 6 hrs.	8°C (46°F) @ 6 hrs.
SM-SA60 SM-SC60	0.6 liter (20 oz.)	0.235 kg (9 oz.)	88°C (190°F) @ 1 hr. / 73°C (163°F) @ 6 hrs.	8°C (46°F) @ 6 hrs.

#### Heat/Cold Retention Testing Conditions:

At a room temperature of 20°C±2°C (68°F±4°F), the Main Body is filled to below the Lid Set with hot or cold water and left standing in an upright position. For heat retention, once the hot water reaches 95°C±1°C (203°F±2°F), the temperature is measured after 1 hour and 6 hours. For cold retention, once the cold water reaches 4°C±1°C (39°F±2°F), the temperature is measured after 6 hours.

Materials: Inner Liner	Stainless Steel (Nonstick Coated)
Exterior	Stainless Steel (Acrylic Resin Painted)
Mouth	Stainless Steel
Stopper	Polypropylene
Lid Cover	Polypropylene
Gasket	Silicon

**Manufacturer: Zojirushi Corporation**

**Address: 1-20-5 Tenma, Kita-ku, Osaka 530-8511, Japan**