



Household Use Only

## Instruction Manual

# STAINLESS MUG Model SM-TAE

### Name of Each Part

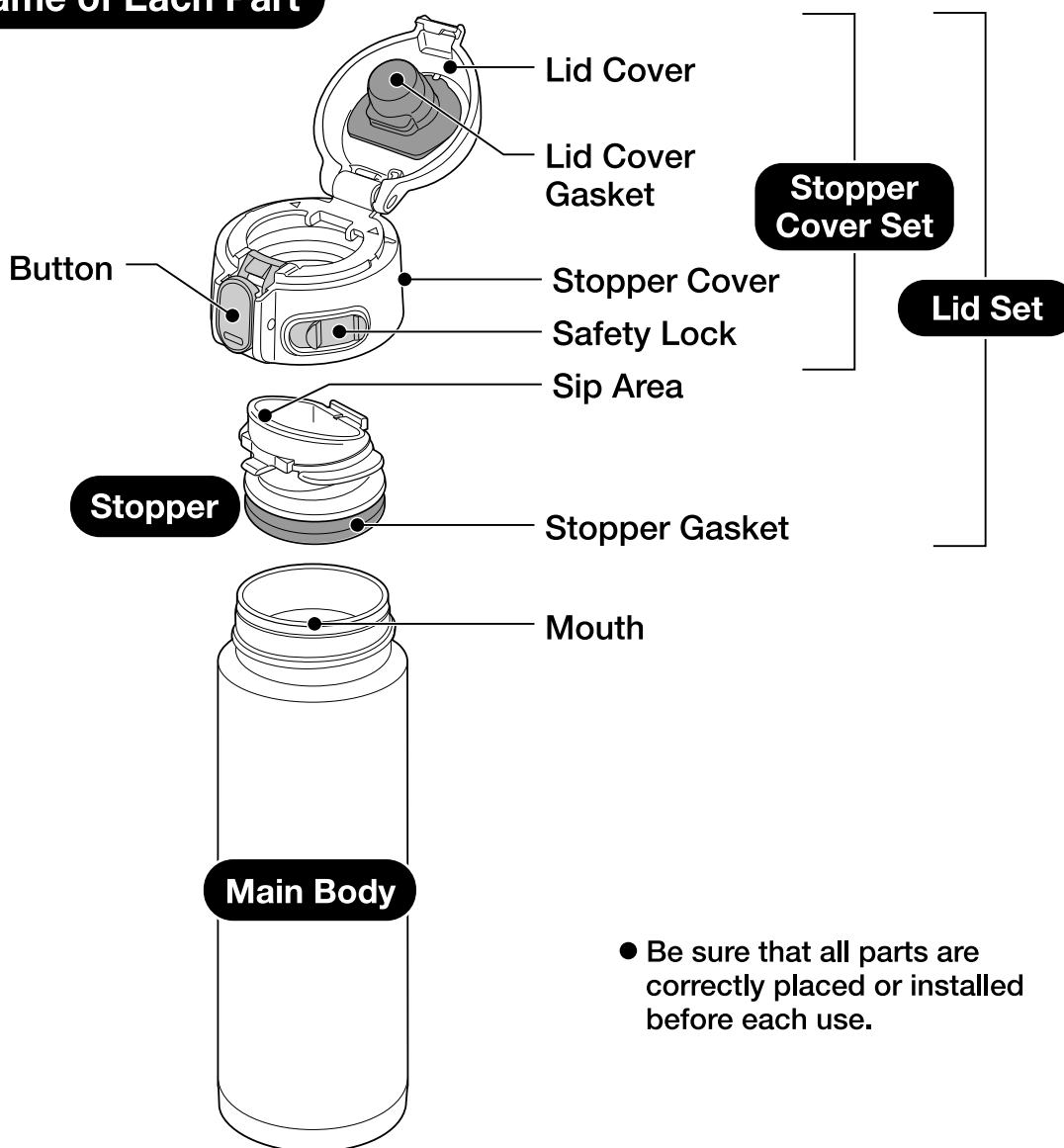

- Be sure that all parts are correctly placed or installed before each use.

● The illustrations used in this instruction manual may differ from the actual product you have purchased.

Please read these instructions before use, and keep for future reference.

SM-TAE (E/Ge/F/S)/A

## Important Safeguards

- Please follow these instructions to prevent scalding, deterioration and discoloration of beverages, as well as malfunction and staining of the Mug.

**Do not allow infants or small children to use this product. Keep out of the reach of infants and small children.**

Mishandling may cause injury or scalding.

**Always make sure that the Lid Cover Gasket and Stopper Gasket are attached during use.**

Contents may leak and cause scalding or stains.

**Do not attach parts other than those specifically designed for this product.**

Doing so may cause leaks or breakage.

**Do not use if the Mug loses its heat retention properties.**

The outside of the Mug may become very hot if hot beverages are poured inside.

**Be sure to set the Lid Set and close the Lid Cover securely after use.**

Contents may leak and cause scalding or stains.

**Leave 1cm (1/2-inch) room on top when filling the Main Body.**

Contents may overflow when placing the Lid Set.

### Drink Level

Leave 1cm (1/2-inch) space below the rim (part A)

Inside of the Main Body

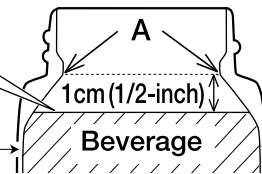

**When containing hot beverages:**

- **Drink slowly without tilting the Mug suddenly.**

There is a possibility that the beverage may spill and cause burns.

- **Do not shake the Mug.**

Doing so may cause scalds or injury.

- **Be careful not to scald yourself when drinking out of the Mug.**

Due to its vacuum insulation, the outside of the Mug will not become hot, while the beverages inside will remain very hot for many hours. Please drink with caution.

- **The pressure inside the Mug may rise, making it difficult to remove the Lid Set. If that happens, open the Lid Cover once, and remove the Lid Set.**

Forcibly removing the Lid Set may make it fly off abruptly, causing injuries or burns.

**Do not allow hot kettles to touch the Mouth of the Main Body.**

The Main Body may tip over, causing scalds.

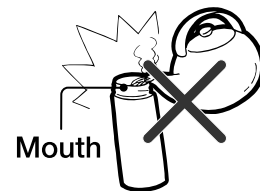

**Do not fill with beverages while the Lid Set is attached.**

Doing so may cause beverages to overfill and may cause burning and scalding.

**Do not place near heat sources such as gas stoves, ovens and heaters.**

Doing so may cause deformation or discoloration of the Mug.

## Important Safeguards continued

- Please follow these instructions to prevent scalding, deterioration and discoloration of beverages, as well as malfunction and staining of the Mug.

---

### Do not open the Lid Cover with the Mug close to your face or tilted toward you.

Hot beverages may suddenly come out or spew out and may cause scalding.

---

### Do not drink out of the Mug while driving.

Doing so may cause scalds or stain the interior of the car or clothes. Attempting to use while driving may also cause serious accidents.

---

### When using a vehicle cup holder accessory:

- ① **Always keep the Lid Cover securely closed when not drinking.**  
Beverage may spill if the Mug is tipped over, causing scalds or injury.
  - ② **Make sure the Mug fits into the holder securely before placing it in.**  
Do not use the Mug if it does not fit into the holder securely as it may tip over and cause scalds, injury or accidents.
  - ③ **Check that the strength of the cup holder is sufficient to hold the Mug before using.**  
The Mug may fall and cause injuries or burns, or stain the interior of the car or clothes if the cup holder does not hold up.
  - ④ **Do not use a hanging-type cup holder that attaches to the window or air vent.**  
The cup holder may fall off.
- **The Mug may not fit into some cup holders.**
- 

### Do not hold the Mug by the Lid Set or the Lid Cover when carrying.

The Mug may fall and cause injuries.

---

### Do not disassemble the Main Body.

---

### Do not heat in a microwave.

Doing so may cause sparks, deformation or discoloration of the Mug.

---

### Do not place near open flames (from gas stoves, etc.), on top of electric heaters or IH hot plates, or other IH cooking devices.

Doing so may cause a fire or malfunction.

---

### Do not fill the Mug with the following:

- **Dry ice and carbonated drinks:** Contents may spill out or the pressure may cause the Lid Set to burst, causing injuries.
  - **Liquids high in sodium such as soup and Kobo-cha:** Although the liner is made of 18/8 stainless steel and is nonstick coated, salt may cause rust resulting in loss of thermal insulation.
  - **Dairy products and fruit juice:** If left inside for a long period of time, contents may spoil and produce gas that may cause the Lid Set to burst, causing injuries.
  - **Fruit pulp and tea leaves:** May become caught on the Stopper Gasket and cause contents to spoil.
- 

### Consume beverages within the same day.

Not doing so may cause spoiling. In addition, if left inside for a long period of time, spoiled beverages may produce gas, raising the pressure inside the Mug and causing the Lid Set to burst or beverages to spill, resulting in injuries and scalding.

---

### This Mug is for storing and keeping beverages hot or cold. Please do not use for other than intended purposes.

---

## Warnings & Cautions

---

**Avoid dropping or hitting against hard surfaces.**

Damage to the plastic or stainless steel surface of the Mug may reduce its ability to retain heat.

---

**Clean the Main Body after every use.**

Not cleaning thoroughly may cause the Main Body to rust, beverages to spoil, or cause pinholes.

---

**Do not remove the sticker on the bottom of the Main Body.**

Doing so may cause rust or holes.



---

**Do not damage the nonstick coating inside the Main Body.**

Scratches may cause rust, holes or other problems.

---

**Do not force large ice cubes in. Break them into smaller pieces instead.**

Doing so may cause deformation or damage to the product.

---

**Always clean the Stopper, Lid Cover Gasket and Stopper Gasket thoroughly after use.**

Not doing so may cause decay, mold, odor or discoloration. It may also cause leaks.

---

**If a cold beverage is put into the product under highly humid conditions, condensation may form on the Lid Set. Stand the product upright when placing it in bags.**

---

**Always disassemble the Lid Set when washing and wipe dry (see p.6-7).**

Water may drip out if it is not dried well.

---

**This product is designed to be drunk from directly. If it is used for pouring, the beverage may splash.**

---

**Do not leave a tea bag inside and set the Lid Set.**

The tea bag may swell and cause leakage or cause drinks to spill out.

---

**Store the Mug upright when carrying inside bags to prevent beverages from spilling.**



**Do not scratch or rub the design on the outside of the Main Body strongly using fingernails or hard objects.**

This may cause the design to come off.

---

**Hot tea may discolor if stored for a long period of time. We recommend the use of tea bags and brewing right before consumption.**

---

**Placing ice cubes in the Mug may cause the internal pressure to decrease and the Lid Cover Gasket may come off when opening the Lid Cover. If this happens, please reattach the Lid Cover Gasket.**

---

**The rattling noise that may be heard when the Main Body is shaken comes from the copper or aluminum foil in the vacuum insulation to increase heat (cold) retention and does not indicate a malfunction.**

---

## How to Use:

- Follow the instructions for care and wash the Lid Set, the inside and outside of the Main Body thoroughly before use.
- When you first use the product, there may be a plastic smell. However, this will become less noticeable with use.

### 1 Remove the Lid Set from the Main Body.

Remove the Lid Set from the Main Body by turning it counterclockwise as illustrated.

Remove the Lid Set

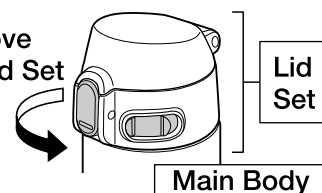

### 2 Fill the Main Body with beverage.

For better heat retention, preheat or precool the Main Body with hot water (cold water) for about one minute, and then fill it with your beverage.

#### Drink Level

Leave 1cm (1/2-inch) space below the rim (part A)

Inside of the Main Body

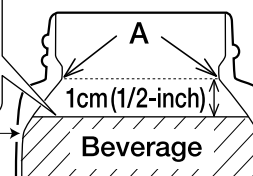

### 3 Set the Lid Set securely.

Close the Lid Cover, lock the Safety Lock\* then turn the Lid Set clockwise as illustrated to set.

\* See illustration 4 below.

- Confirm that the Stopper Gasket and Lid Cover Gasket are correctly attached before using. (If not correctly attached, the beverage may leak.)
- Firmly attach the Lid Set to the upright Main Body, lining up the Zojirushi logo mark with the front of the Lid Set.
- Attach the Lid Set properly and turn the Mug upside down to make sure contents do not leak.

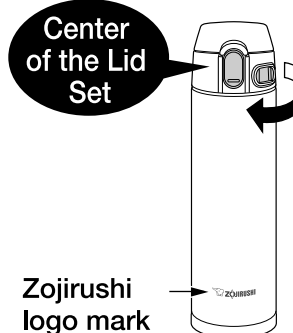

### 4 Unlock the Safety Lock.

Slide the Safety Lock to the right (  ) to unlock.

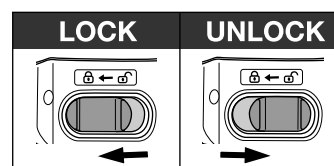
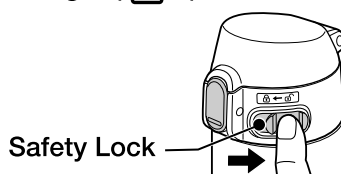

## How to Use: continued

### 5 Open the Lid Cover.

Push the Button and release to open the Lid Cover.

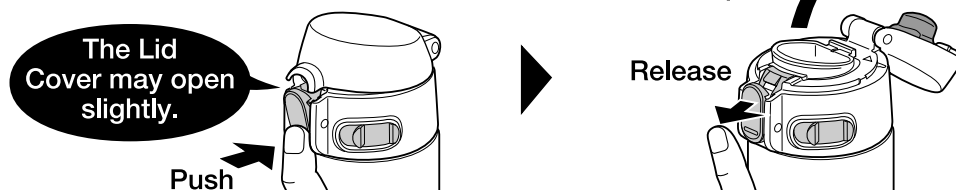

### 6 Drink the beverage.

- Do not tilt the Mug suddenly when drinking.  
(The beverage may spill and cause scalding or stain clothes.)

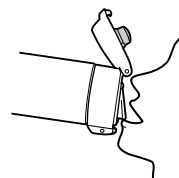

### 7 Close the Lid Cover and lock.

- ① With the Mug at an upright position, close the Lid Cover until it clicks.
  - ② Slide the Safety Lock all the way to the left to lock (see p.5 illustration 4 ).
- Do not leave the Mug with the Lid Cover open.
  - Always close the Lid Cover securely at an upright position.

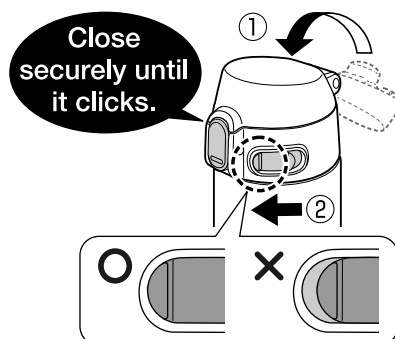

## How to Disassemble the Lid Set:

### 1 Remove the Stopper.

With the Lid Cover open, hold the Lid Set as illustrated, and press on the back of the Sip Area (parts indicated by the ▽ marks) to remove the Stopper.

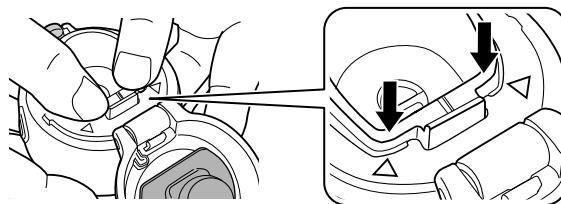

### 2 Remove the Stopper Gasket.



## How to Disassemble the Lid Set: continued

### 3 Remove the Lid Cover Gasket.

Pinch the edge of the Lid Cover Gasket as illustrated and pull it toward you to remove.

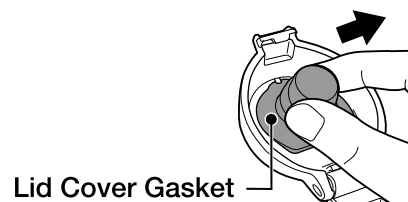

## How to Assemble the Lid Set:

- Be sure to attach the Stopper Cover Set, Lid Cover Gasket, Stopper and Stopper Gasket correctly to prevent malfunction or leaking of beverages.

### 1 Attach the Lid Cover Gasket.

Align the Small Opening on the Lid Cover Gasket with the protrusion on the Lid Cover and press to attach.

- Be sure to set the Lid Cover Gasket before use.

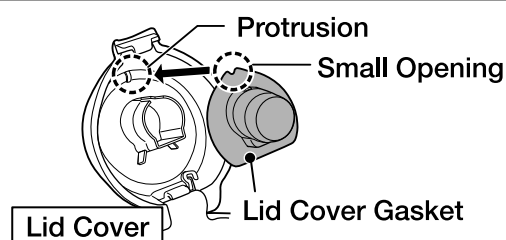

### 2 Attach the Stopper Gasket.

Line up the recess in the Stopper Gasket with the ridge on the Stopper, and, applying pressure from the outside in, push it into place.

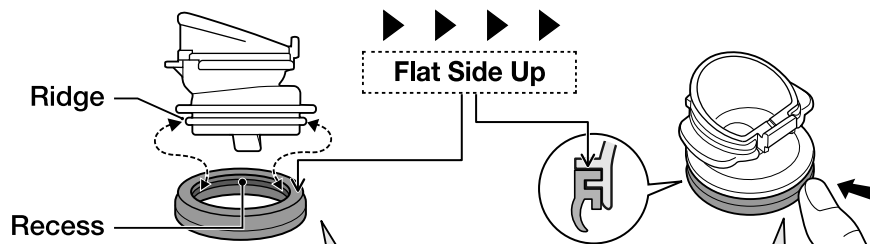

Be careful with the top and the bottom of the gasket and be sure to set correctly. Not doing so may cause beverages to leak.

Push along the rim with your finger.

### 3 Attach the Stopper.

Align the opening of the Stopper Cover Set and the tab of the Stopper, and press the Stopper in to attach securely.

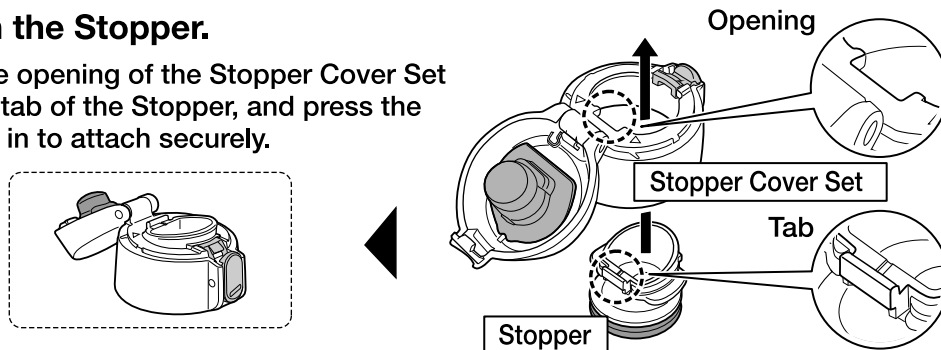

## How to Take Care of Your Mug:

- Clean the product after each use to prevent odors and mold, and to keep the product sanitary.
- Always disassemble the product before cleaning. (see p.6-7)

### Exterior Lid Set

- ① Wash with warm water and mild dishwashing liquid using a soft sponge.
- ② Rinse, shake a few times and wipe dry.
  - When washing the Lid Set, disassemble it first then wash and dry.
  - Use a small brush sold in stores if necessary.

### Interior

- ① Wash with warm water and mild dishwashing liquid using a soft sponge with handle.
- ② Then rinse and wipe moisture out to dry.

## When Cleaning Your Product:

### To protect the paint, print or stickers on the outside of the Main Body:

- Do not use a dishwasher or dish-dryer. Do not boil to sanitize.
- Do not use bleach on the outside of the Main Body.
- Do not clean using paint thinner, metal wire scrub brushes, scrubbing brushes that include abrasive cleaners, polishing powders, cleansers, melamine sponges, or any similar items.
- Do not use chlorine type bleach.
- Do not soak in water for an extended period of time.
- Wipe moisture off thoroughly to prevent water stains or rusting.
- If the product is not going to be used for an extended period, wash thoroughly with cold or lukewarm water and dry well. Store the product away from high temperatures and humidity.

High temperatures and humidity may damage the product.

## To Remove Rust Spots and Water Stains:

You may find rust spots or water stains caused by impurities in the water. To remove these stains, fill the Main Body with hot water with 10% vinegar and let it stand for 30 minutes to an hour without attaching the Lid Set, then wash the interior thoroughly.

## Replacing the Lid Cover Gasket, Stopper or Stopper Gasket:

We take care in only using materials that are safe and hygienic for food contact. However, if plastic parts become damaged or its surface becomes rough, please replace them for optimum performance. The Stopper may need to be replaced due to time and wear. Please check them about once a year. When replacing parts, please record the model number and part name beforehand. Then contact either the store where you purchased the product or Zojirushi Customer Service. Replacement parts may be available for an additional charge.