

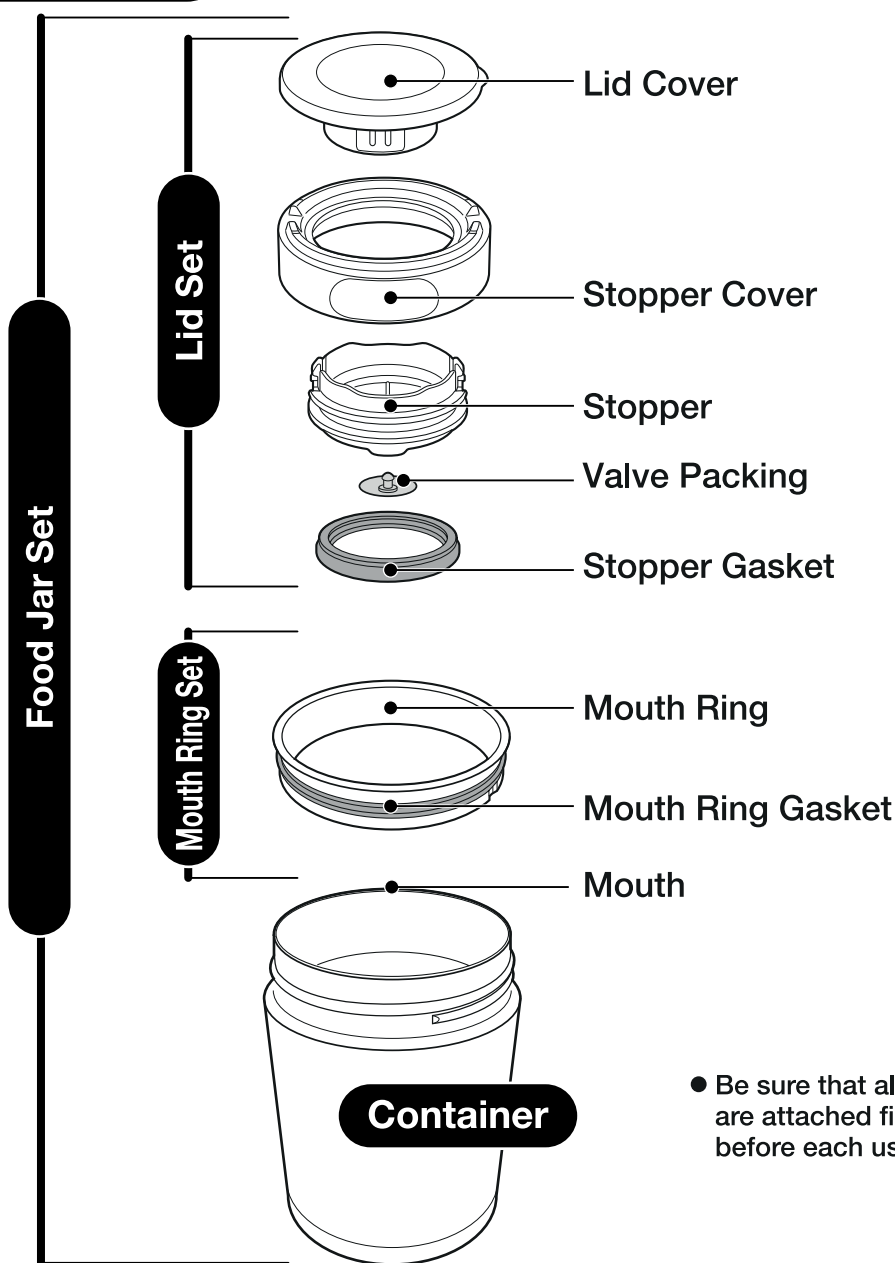

Stainless Steel Food Jar

Household Use Only
INSTRUCTION MANUAL
Model No. SW-GCE

Name of Each Part



Please read before use. Keep these instructions for future references.

Important Safeguards

- Please follow these instructions to prevent scalding, deterioration and discoloration of foods and beverages, as well as malfunction and staining of the product.

Do not allow infants or small children to use this product. Keep out of the reach of infants and small children.

Mishandling may cause injury or scalding.

Avoid placing near heat sources such as heaters and gas stoves.

Doing so may cause deformation or discoloration of the product.

This product is for keeping foods and beverages hot or cold. Do not use it for any other purposes.

Avoid leaving in direct sunlight for an extended period.

Doing so may cause discoloration of the product.

Always close the Lid Set securely when using.

Foods and beverages may leak and cause scalds or stain clothes.

Avoid laying this product on its side.

Doing so may cause foods and beverages to leak.

Do not use this product if it loses its heat retention properties.

The outside of the Container may become very hot if hot foods or beverages are poured inside.

Consume foods or beverages as soon as possible (within 6 hours), and do not leave leftovers inside.

Leftover contents may spoil.

Do not heat the Container in a microwave oven.

Doing so may cause sparks, deform or discolor the Container.

When containing hot foods or beverages:

- **Avoid shaking the Container.**

Doing so may cause scalds or injury.

- **Be careful to avoid scalding yourself when using this product.**

Due to its vacuum insulation, the outside of the Container will not become hot, while hot foods and beverages will remain very hot for many hours. Please use caution when eating or drinking.

- **Always use with the Lid Cover in place.**

The interior of the Lid Set may become hot and cause scalds or injury.

Only fill foods and beverages below the fill line.

Overfilling may cause the contents to overflow when the Lid Set is tightened or to leak out afterwards, and may be dangerous.

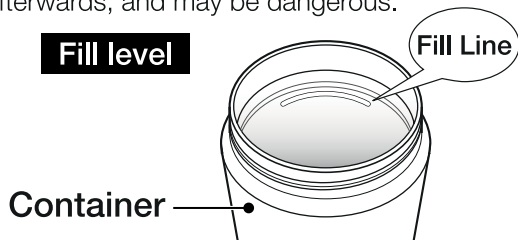

Avoid modifying or disassembling the product.

Doing so may cause accidents or damage the product.

Avoid using this product while driving.

Doing so may cause scalds or stain the interior of your car or clothes. Attempting to use while driving may also cause serious accidents.

Always make sure cold soups or foods and beverages containing dairy products are cooked (heated) through before placing them in the Container.

They may spoil.

Important Safeguards

- Please follow these instructions to prevent scalding, deterioration and discoloration of foods and beverages, as well as malfunction and staining of the product.

Always use with the Lid Cover, Stopper Cover, Stopper, Valve Packing, Stopper Gasket and Mouth Ring Gasket attached.

Contents may leak and/or cause scalding.

Do not remove the sticker from the bottom of the Container.

Doing so may cause rust, holes or other damage.

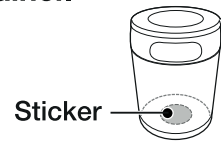

Never put the following into the Container:

- **Dry ice and carbonated drinks**

Contents may spray out or the pressure may cause the Lid Set to burst, causing injuries.

- **Fresh foods (uncooked/unsalted meat, seafood, dairy products etc.)**

If left inside the Container for an extended period, these may spoil and give off gases. A buildup of pressure from these gases within the Container may make food or beverages spray out or burst the Lid Set.

Follow these instructions when placing salads/fruit in the Container.

- **Use fresh (just purchased) salads/fruit. Wash well under running water before using.**
- **Wash hands thoroughly before preparing foods.**
- **Avoid using kitchen knives and chopping boards which have been used for meat or fish. If you do use such knives or boards for salads/fruit, disinfect them beforehand.**
- **Cut salads/fruit and cool well in the refrigerator before placing in the Container.**

Avoid using to keep food hot or cool for extended periods. Wash Container, Stopper Cover, Stopper, Valve Packing, Stopper Gasket, Mouth Ring and Mouth Ring Gasket immediately after use.

If you are away from home and thorough cleaning is not possible, rinse the inside of the Container with water immediately after use.

- **Although the liner is made of 18/8 stainless steel, salt from foods such as miso soup, other soups and sports drinks may cause rust resulting in loss of thermal insulation.**
- **A buildup of pressure inside the Container from gases given off by a beverage as it spoils may make the Lid Set fly off or burst when it is opened, causing foods or beverages to spray out and cause injury.**
- **Not doing so may cause decay, mold, odor or discoloration. It may also cause leaks.**

Warnings & Cautions

Avoid dropping or hitting against hard surfaces.

Damage to the plastic or stainless steel surface of the product may reduce its ability to retain heat.

Do not place cans, bottles, etc. inside the Container.

These may deform or damage the Container.

After washing the Lid Set, remove all water from the parts by shaking them repeatedly and wiping them before reassembly.

Droplets of water remaining on the Lid Cover, Stopper Cover or Stopper may leak out. (See p. 6 for disassembly instructions.)

Do not attach parts other than those specifically for this product.

Doing so may cause leaks or breakage.

Do not allow a hot kettle to touch the Mouth Ring or mouth of the Container.

The Container may tip over, causing scalds, or damaging or deforming the product.

Avoid carrying the Container by the Lid Set or Mouth Ring Set.

Dropping the Container may cause injury.

Break up large ice cubes into smaller pieces before placing them in the Container.

Forcing large cubes into the Container may deform or damage it.

Do not strongly rub the design on the outside of the Container.

It may come off.

Foods with strong odors or colors (curry, kimchee and pickled daikon radish, or shiso, spinach, carrots and other brightly colored vegetables) may cause the product to absorb odors or discolor the Lid Set.

● Stand the Container upright when opening or closing the Lid Set.

● When carrying the product in a bag, keep it upright to prevent any leaking of contents.



Filling the Container with hot foods or beverages may cause buildup of pressure within it, making the Lid Set difficult to remove. In this case, remove the Lid Cover and push a small, rounded object such as the back of a toothpick into the hole in the center to release the pressure, taking care not to tear the Valve Packing. (See illustration on the right.)

Center of the Stopper

Toothpick or similar

2 holes

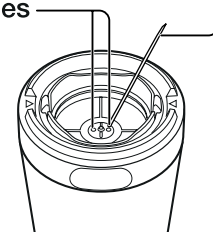

The rattling noise that may be heard when the Container is shaken comes from the copper or aluminum foil in the vacuum insulation to increase heat (cold) retention and does not indicate a malfunction.

● The illustrations used in this instruction manual may vary from the actual product you have purchased.

Instructions for Use

● Before using, wash the Lid Set, Mouth Ring Set and interior of the Container thoroughly with lukewarm water.

1 Remove the Lid Set from the Container

Without removing the Lid Cover, remove the Lid Set by twisting it in the direction of the arrow.

Remove

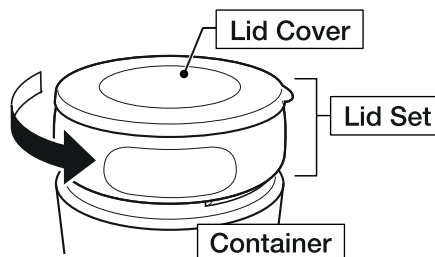

2 Preheat (Precool)

- ① For better heat/cold retention, pre-heat/pre-cool the Container by pouring hot water/cold water up to the Fill Line, closing the Lid Set and then letting it stand for 1-2 minutes.
- ② After preheating/precooling, discard the hot water/cold water and wipe off any moisture.

3 Fill the Container

- Overfilling the Container may cause the contents to overflow when the Lid Set is tightened or leak out afterwards. Only fill foods and beverages below the fill line.



- Wipe off any food or beverage adhering to A (to prevent leakage of contents after closing the Lid Set).
- Heat/cool foods and beverages thoroughly before placing them in the Container.

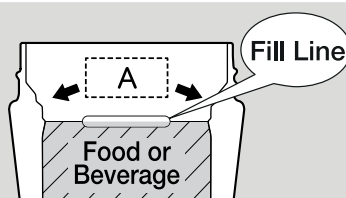

4 Close the Lid Set

- To prevent foods or beverages from leaking, ensure that the Lid Cover, Valve Packing and Stopper Gasket are correctly inserted before using the Container.
- Holding the Container upright, close the Lid Set firmly.
- Turn the Container upside down to check that there are no leaks.
- Always use the Lid Set with the Lid Cover firmly attached.

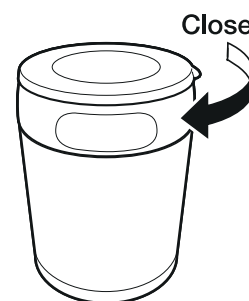

Disassembling the Lid Set

1 Remove the Lid Set from the Container

2 Remove the Lid Cover
Hold the Tab and pull apart as illustrated.

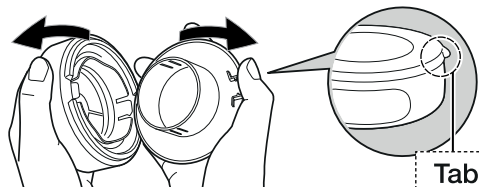

3 Remove the Stopper
Push the Tabs in, then push the Stopper out.

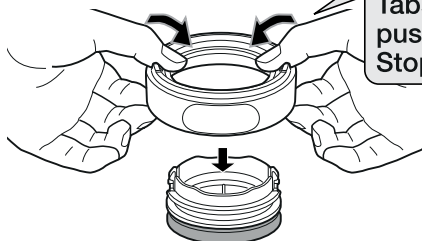

Push the Tabs on the Stopper in toward the center to remove the Stopper. (Lining up the Tabs on the Stopper with the \triangleright \triangleleft marks will make the Stopper easy to remove.)

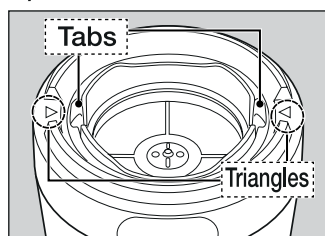

4 Remove the Valve Packing

When removing the Valve Packing, be careful not to damage it with your nails.

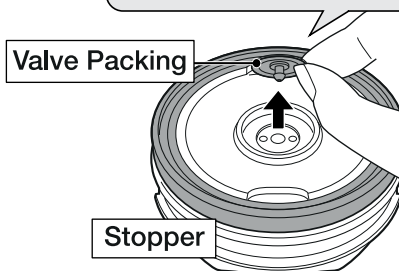

The Valve Packing is fitted in the center of the Stopper. Remove it using finger and thumb as shown in the illustration.

● The Lid Set has a hollow structure for thermal insulation. Remove the Lid Cover to clean inside the cavity.

5 Remove the Stopper Gasket

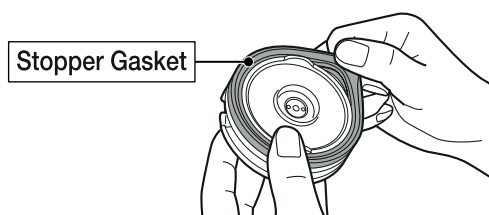

Disassembling the Mouth Ring Set

1 Remove the Mouth Ring Set from the Container as shown.

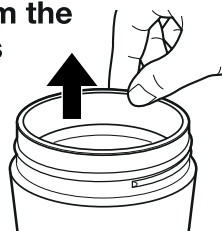

2 Remove the Mouth Ring Gasket by using a toothpick or something similar.

Be careful not to damage the Mouth Ring Gasket.

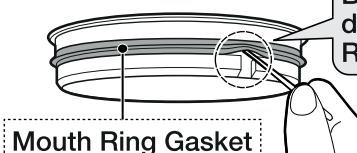

Assembling the Lid Set

1 Attach the Stopper Gasket

Line up the recess in the Stopper Gasket with the ridge on the Stopper, and, applying pressure from the outside in, push it into place.

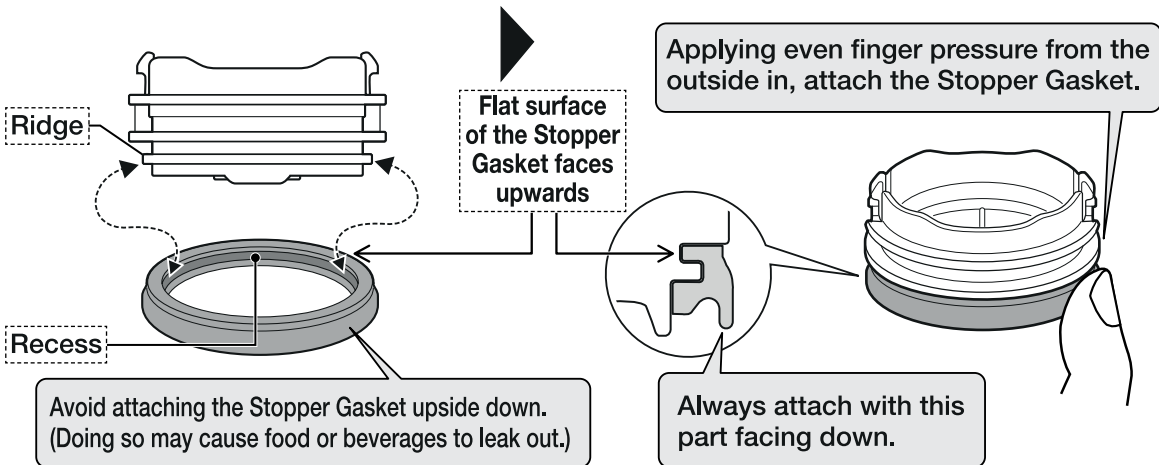

2 Attach the Valve Packing

As shown in the illustration, push the projection on the Valve Packing securely into the hole in the center of the Stopper.

- Foods or beverages may leak if the Valve Packing is not correctly attached.

※ There are 3 holes on the Stopper. Please insert the projection into the center hole.

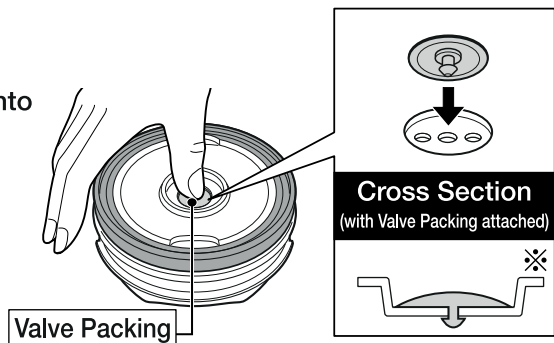

3 Attach the Stopper to the Stopper Cover

Align the openings of the Stopper Cover and the Tabs of the Stopper, and press the Stopper in to attach securely.

- Please make sure that both Tabs click in securely.

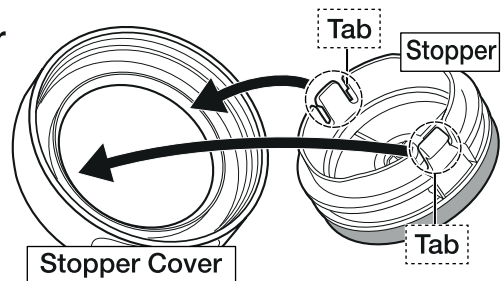

4 Attach the Lid Cover

Align the Tab on the underside of the Lid Cover with the opening on the Stopper Cover and attach firmly.

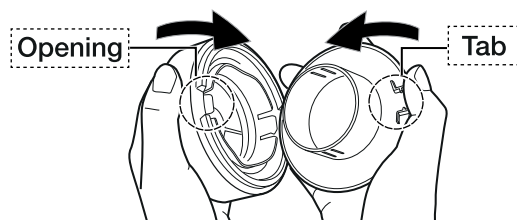

Assembling the Mouth Ring Set

- 1 With the ridge in the Mouth Ring Gasket facing out, attach the Gasket securely into the groove in the Mouth Ring.

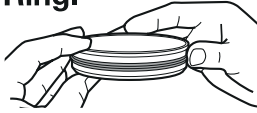

After attaching the Gasket, press it in with your fingers.

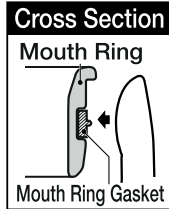

- 2 Twist the Mouth Ring Set slightly while pushing it firmly onto the Container.

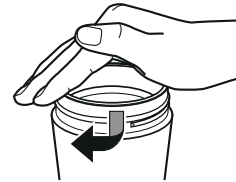

- After attaching the Gasket, adjust it with your fingers to ensure that it is not twisted or bulging.
- If the Mouth Ring Gasket or Mouth Ring Set is not attached correctly, it may pinch your lips or hands and cause injury. It may also cause foods and beverages to leak.

Care of Your Product

- Always disassemble the product before cleaning it. (See p. 6.)

- Clean the product after each use to prevent odors and mold, and to keep the product sanitary.

Food Jar Set

- ① Wash with a sponge dipped in lukewarm water and mild kitchen detergent.
 - ② After rinsing, shake several times and thoroughly wipe dry.
- Remove the Valve Packing and Stopper Gasket from the Lid Set and the Mouth Ring Gasket from the Mouth Ring before washing.
 - Allow the parts of the Lid Set and Mouth Ring Set to dry before you reassemble them.
 - After disassembling the Lid Set and Mouth Ring Set for cleaning, reassemble it correctly to prevent foods and beverages from leaking. (See assembly instructions on p. 7-8.)

Taking Care of Your Product:

- Do not boil to sanitize. Do not use a dishwasher or dish-dryer.
 - Do not use bleach on the exterior of the Container.
- Doing so may remove paint, print or stickers from the Container.**
- If the product is not going to be used for an extended period, wash thoroughly with cold or lukewarm water and dry well. Store the product away from high temperatures and humidity. These may damage the product.
 - Do not use thinner, benzene, wire wool, scouring pads, polishing powder, cleansers, etc. to clean the product.
 - Do not use chlorine bleach.
 - The product is washable, but do not soak it.
 - After washing the Container, always wipe moisture off thoroughly to prevent water stains or rust.
 - Always wipe off any water between the Lid Cover, Stopper Cover and Stopper.

Removing Rust Spots and Water Scale:

During use of this product, hardness or impurities in water may cause rust spots or water scale. To remove these, fill the Container with hot water with approximately 10% vinegar and let stand with the Lid Set off for 30 minutes to an hour, then wash the interior thoroughly. (See "Care of Your Product", p. 8.)

Care of Your Product (continued)

Treating Absorbed Odors:

If the product is left unwashed for an extended period or is not thoroughly washed, it may absorb an unpleasant odor, and discoloration of the plastic parts may occur. Treat any unpleasant odor absorbed by the product as follows.

Container, Lid Cover, Stopper Cover, Stopper, Mouth Ring	After washing thoroughly, wipe off moisture and leave in a well-ventilated place in sunlight to dry for 1-2 hours. If this does not remove the odor, we recommend using Zojirushi's cleaning detergent SB-ZA01/SB-ZA01E. Always remove the Lid Set when using SB-ZA01/SB-ZA01E. Contact Zojirushi Customer Service or your local dealer for further information.
Valve Packing, Stopper Gasket, Mouth Ring Gasket	Boil for 10 minutes in water with approximately 10% vinegar. After rinsing, wipe off moisture thoroughly to dry.

Replacing the Valve Packing, Stopper Gasket and Mouth Ring Set:

We take care in only using materials that are safe and hygienic for food contact. However, if plastic parts become damaged or its surface becomes rough, please replace them for optimum performance. The Valve Packing, Stopper Gasket and Mouth Ring Set (Mouth Ring, Mouth Ring Gasket) may need to be replaced due to time and wear. Please check them about once a year. When replacing parts, please record the model number and part name beforehand. Then contact either the store where you purchased the product or Zojirushi Customer Service. Replacement parts may be available for an additional charge.

SPECIFICATIONS:

Product: STAINLESS STEEL FOOD JAR

Model No.	Capacity	Weight	Heat Retention (Above)	Cold Retention (Below)
SW-GCE26	0.26 liter (9 oz.)	0.25 kg (9 oz.)	50°C (122°F) @ 6 hrs.	11°C (52°F) @ 6 hrs.
SW-GCE36	0.36 liter (12 oz.)	0.28 kg (10 oz.)	57°C (135°F) @ 6 hrs.	10°C (50°F) @ 6 hrs.

■ At a room temperature of 20°C ± 2°C (68°F ± 4°F), the Container is filled to the neck with hot or cold water and left standing in an upright position. For heat retention, once the hot water reaches 95°C ± 1°C (203°F ± 2°F), the temperature is measured after 6 hours. For cold retention, once the cold water reaches 4°C ± 1°C (39°F ± 2°F), the temperature is measured after 6 hours.

Materials:	Inner Liner	Stainless Steel
	Exterior	Stainless Steel (Acrylic Resin Painted)
	Mouth of the Container	Stainless Steel
	Stopper	Polypropylene
	Mouth Ring	Polypropylene
	Gasket & Packing	Silicon

Manufacturer: Zojirushi Corporation

Address: 1-20-5 Tenma, Kita-ku, Osaka 530-8511, Japan