

**Name of Each Part**

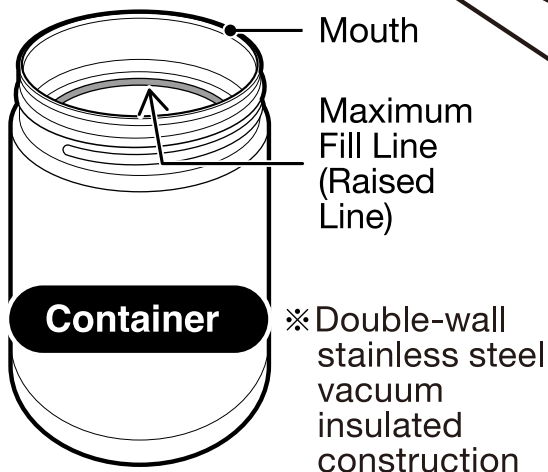

**How to Use:**

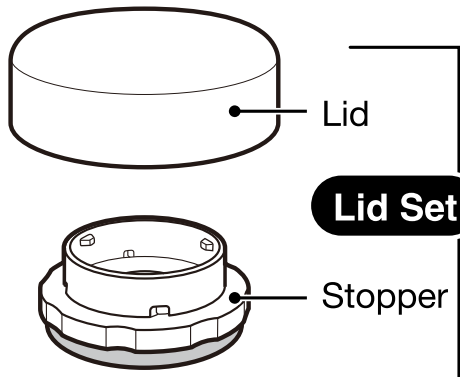
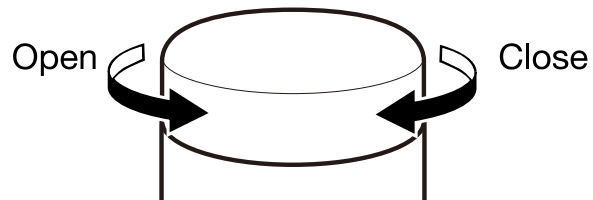

**Designed to release pressure when opening.**

- While removing the Lid Set some resistance may be experienced midway. This is normal. Please keep turning it to remove.
- The Stopper may feel loose when removing the Lid Set. This is not a malfunction.

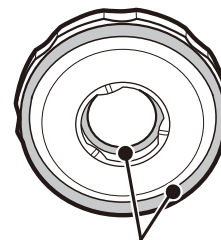
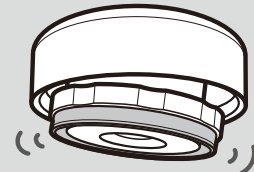

**\* The Gasket is not removable.**

- Please read these instructions before use, and keep for future reference.
- The illustrations used in this instruction manual may differ from the actual product you have purchased.





## How to Disassemble the Lid Set:

### Remove the Stopper from the Lid

Turn the Stopper in the direction of the arrow ( ↻ ) while pulling it in the direction of ( a ) to remove it.

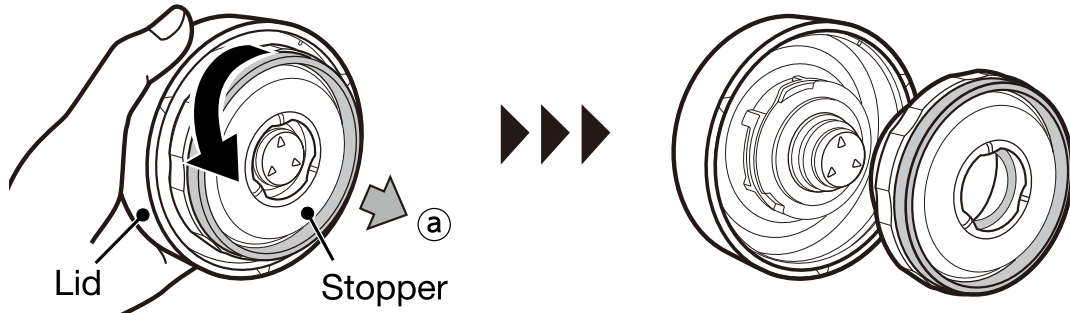

## Assembling the Lid Set

### Attach the Stopper to the Lid

① Align the  $\Delta$  on the Lid with the  $\square$  on the Stopper.

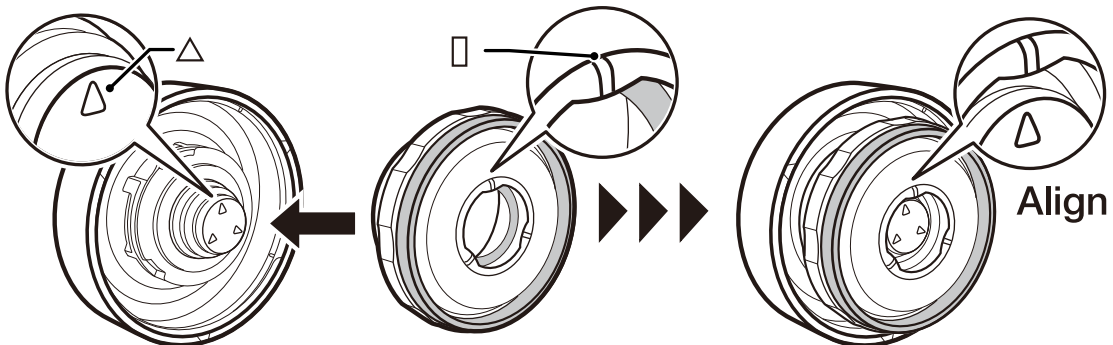

② Turn the Lid in the direction of the arrow to align the next  $\Delta$  on the Lid with the  $\square$  on the Stopper.



## How to Take Care of Your Product:

- Thoroughly clean the product before use.
- When you first use the product, there may be a plastic smell. However, this will become less noticeable with use.
- Clean the product after each use to prevent odors and mold, and to keep the product sanitary.
- Always disassemble the product before cleaning.

### When Cleaning Your Product:

- Do not boil or use a dishwasher or dish-dryer.
- Do not clean using paint thinner, polishing powders, abrasive cleansers, scrub brushes (nylon, metal wire, etc.), melamine sponges, the nylon side of an abrasive sponge, or any similar items.
- Do not use bleach as it may damage the product. Zojirushi's designated cleaning detergent SB-ZA01E may be used to clean the interior of the Container and the Lid.
- The Container is fully washable, but do not soak it in water for an extended period of time.
- If the product is not going to be used for an extended period, wash thoroughly and dry well. Store the product away from high temperatures and humidity.

### Regular Care

- ① Using mild kitchen detergent diluted with lukewarm water, wash the Lid Set and the outside of the Container with a sponge and the inside of the Container with a soft sponge with a handle.  
Use a small brush if necessary.
  - ② Rinse, wipe away remaining water, and leave to dry thoroughly.
- Streaks or smudges caused by rubbing on the coated portion of the Container that cannot be removed by the above method can be removed using a soft eraser.

### What to Do If Rust Spots Form on the Container

- ① Fill the Container with hot water with 10% vinegar without attaching the Lid Set.
- ② After 30 minutes to an hour, wash the interior thoroughly.

### What to Do If the Product Absorbs Odors

#### Container Lid Set

Wash thoroughly and dry with a soft cloth. Place in the sun and let dry for 1-2 hours.

### Replacing the Lid:

We take care in only using materials that are safe and hygienic for food contact. However, if plastic parts become damaged or their surface becomes rough, please replace them for optimum performance. The Lid Set may need to be replaced due to time and wear. Please check them about once a year. When replacing parts, please record the model number and part name beforehand. Then contact either the store where you purchased the product or Zojirushi Customer Service. Replacement parts may be available for an additional charge.